

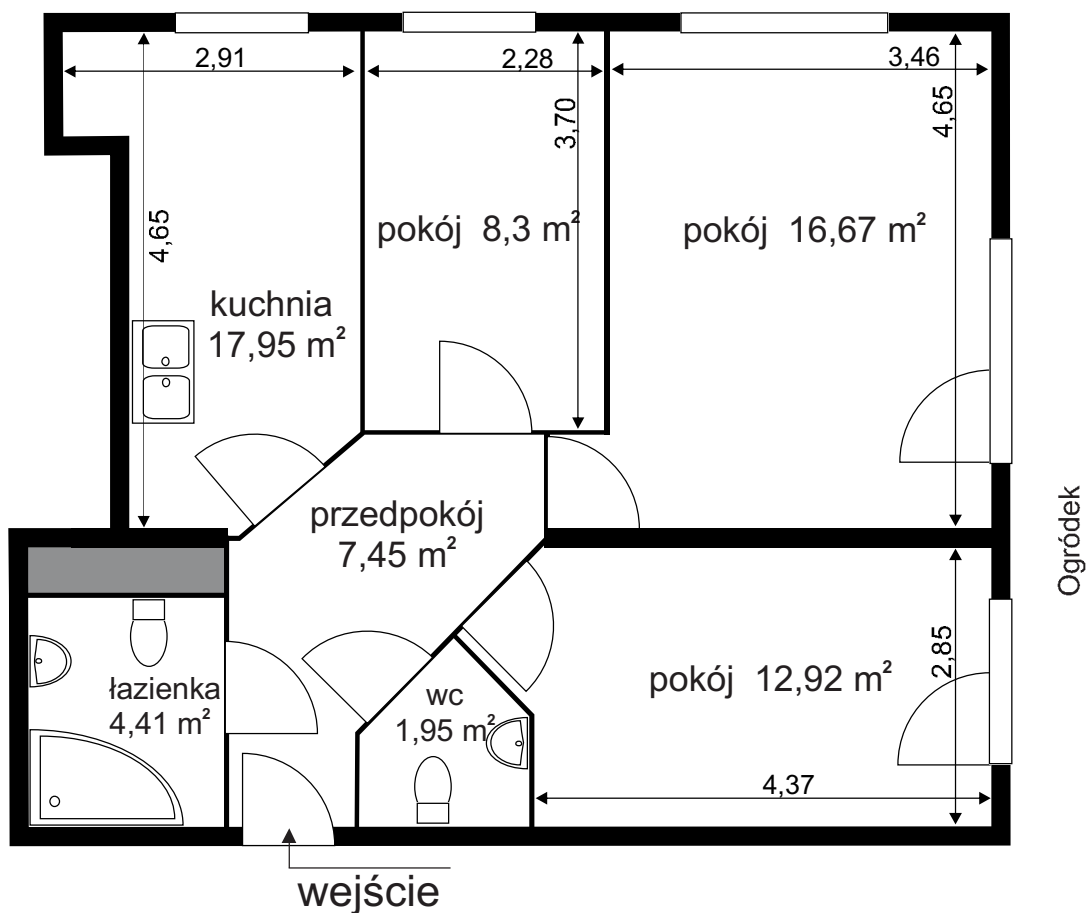

## **Mieszkania w budynku nr 17**

# OLMONT INVESTMENS Sp. z o.o.

ul. Ryżowa 41 02-495 Warszawa tel. (22) 867 54 37, 867 59 16 kom. 604 222 622

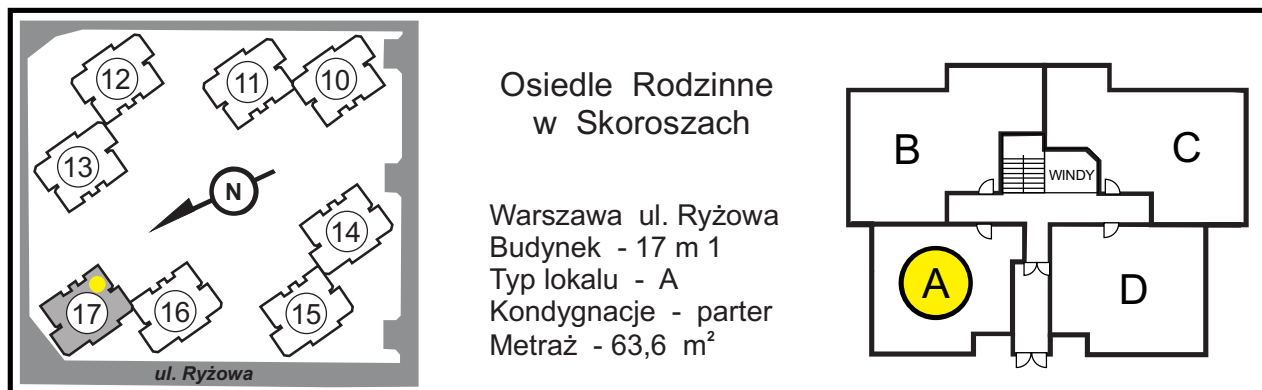

# OLMONT INVESTMENS Sp. z o.o.

ul. Ryżowa 41 02-495 Warszawa tel. (22) 867 54 37, 867 59 16 kom. 604 222 622

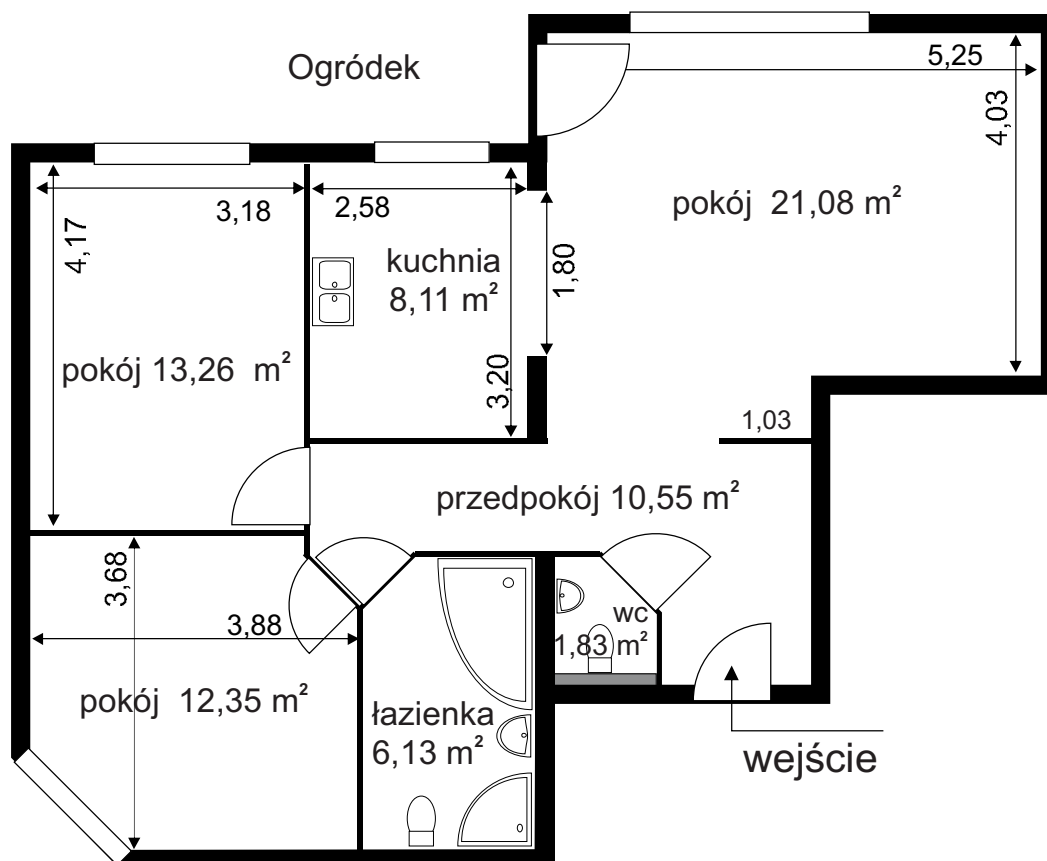
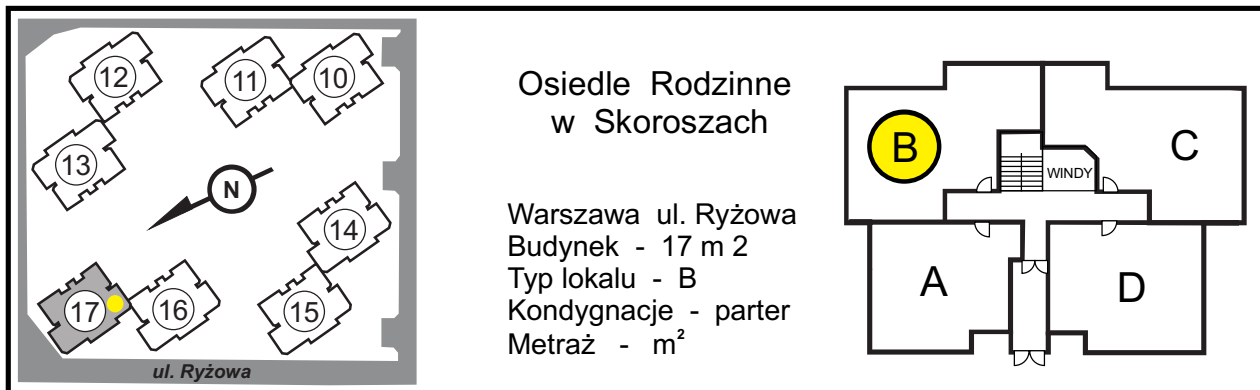

# OLMONT INVESTMENS Sp. z o.o.

ul. Ryżowa 41 02-495 Warszawa tel. (22) 867 54 37, 867 59 16 kom. 604 222 622

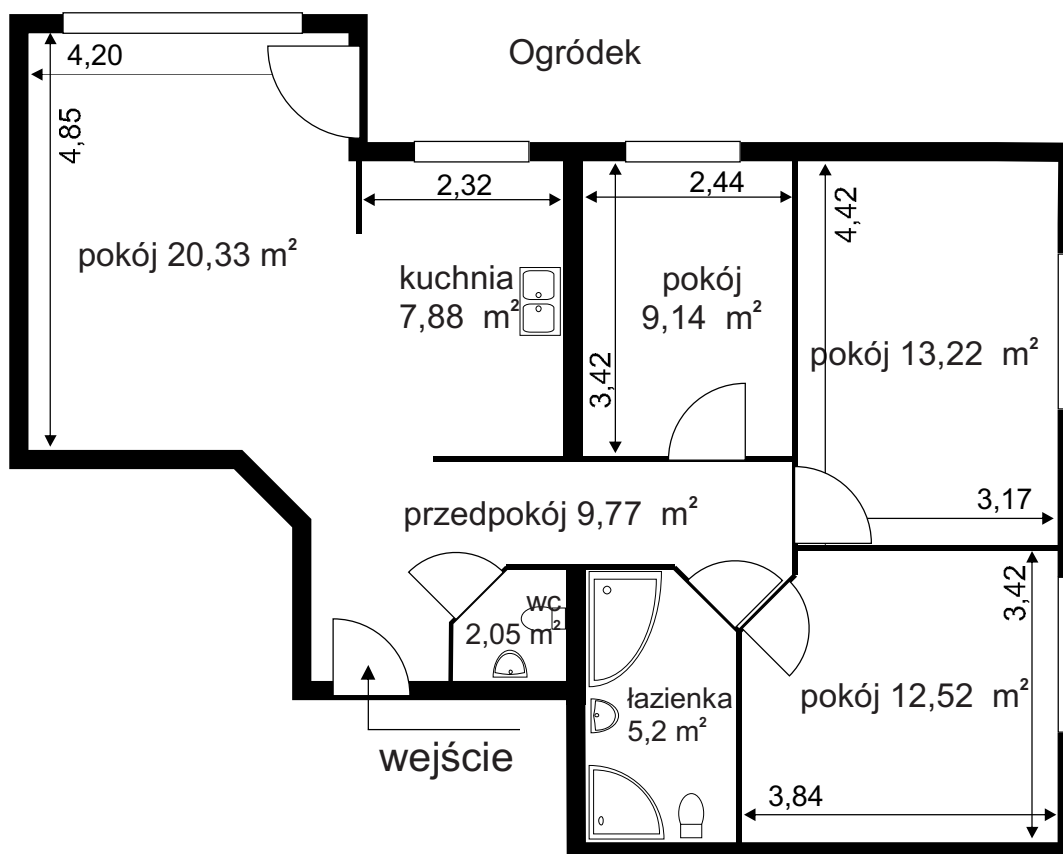
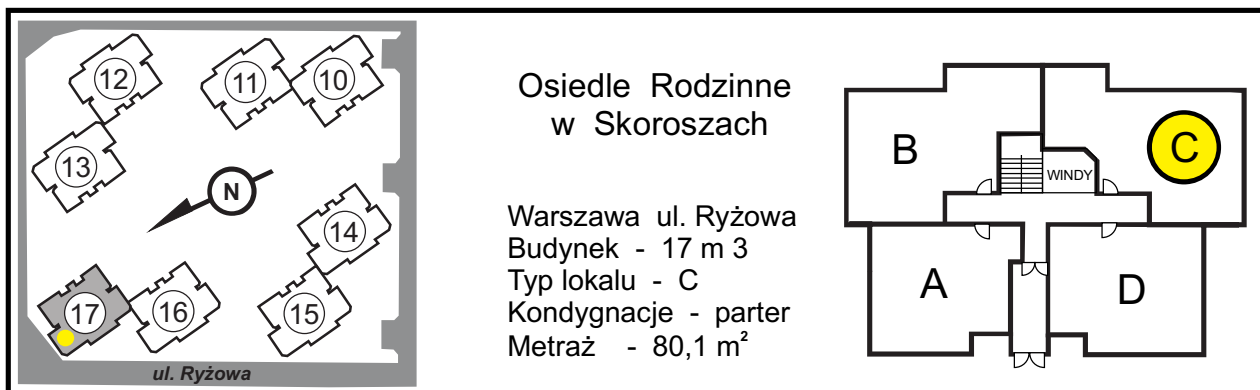

# OLMONT INVESTMENS Sp. z o.o.

ul. Ryżowa 41 02-495 Warszawa tel. (22) 867 54 37, 867 59 16 kom. 604 222 622

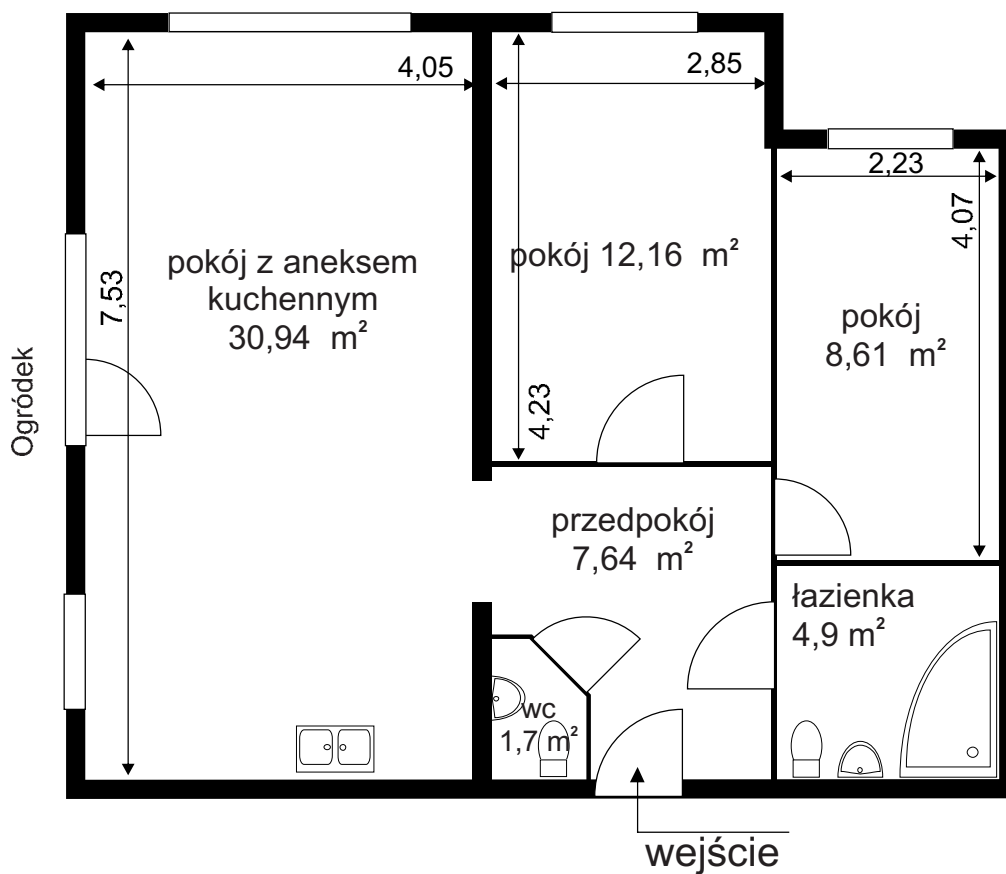
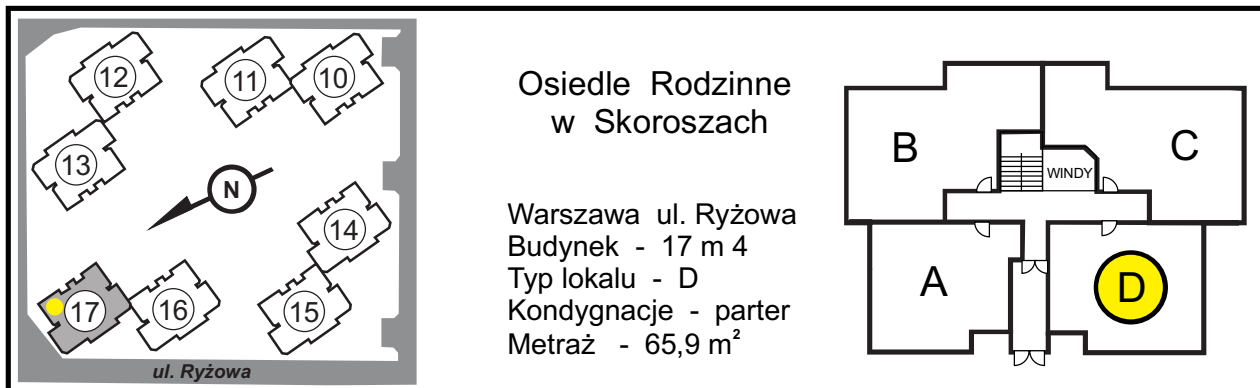

# OLMONT INVESTMENS Sp. z o.o.

ul. Ryżowa 41 02-495 Warszawa tel. (22) 867 54 37, 867 59 16 kom. 604 222 622

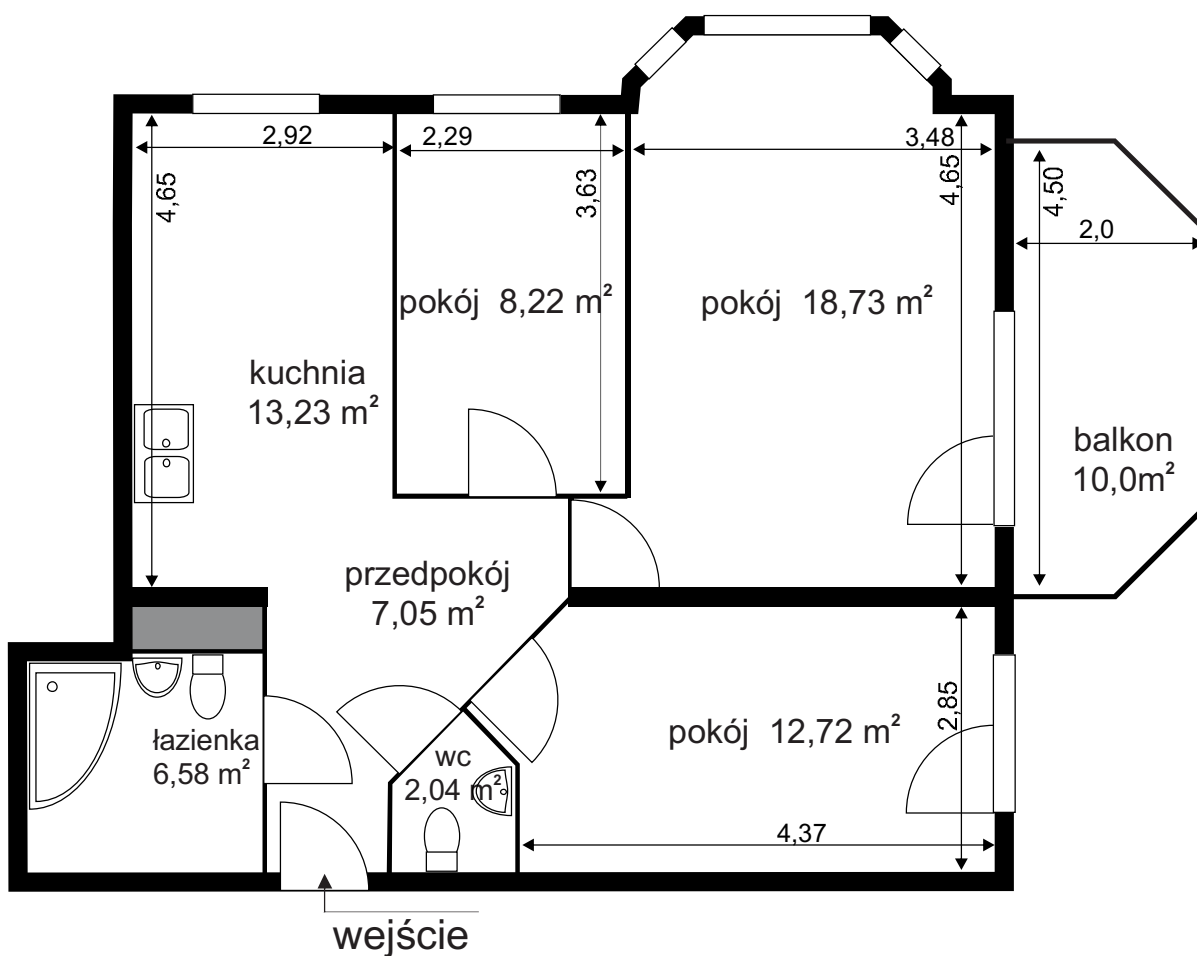
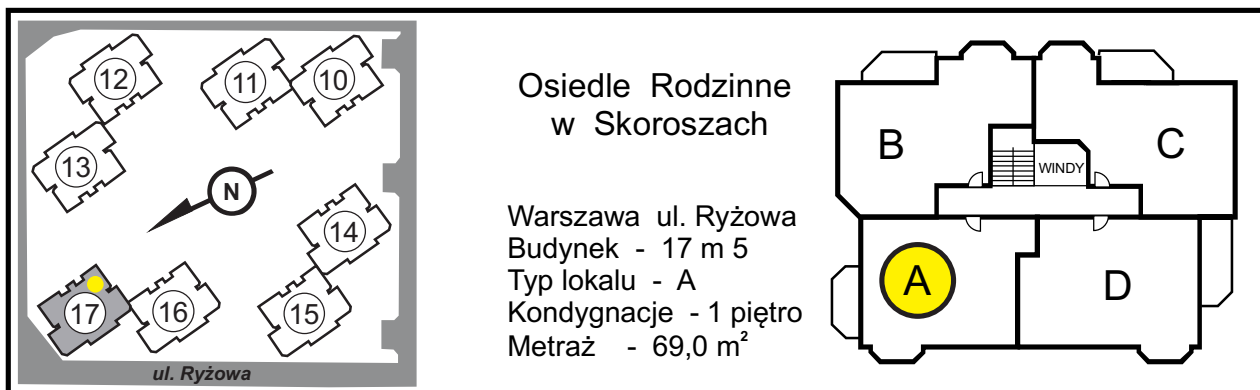

# OLMONT INVESTMENS Sp. z o.o.

ul. Ryżowa 41 02-495 Warszawa tel. (22) 867 54 37, 867 59 16 kom. 604 222 622

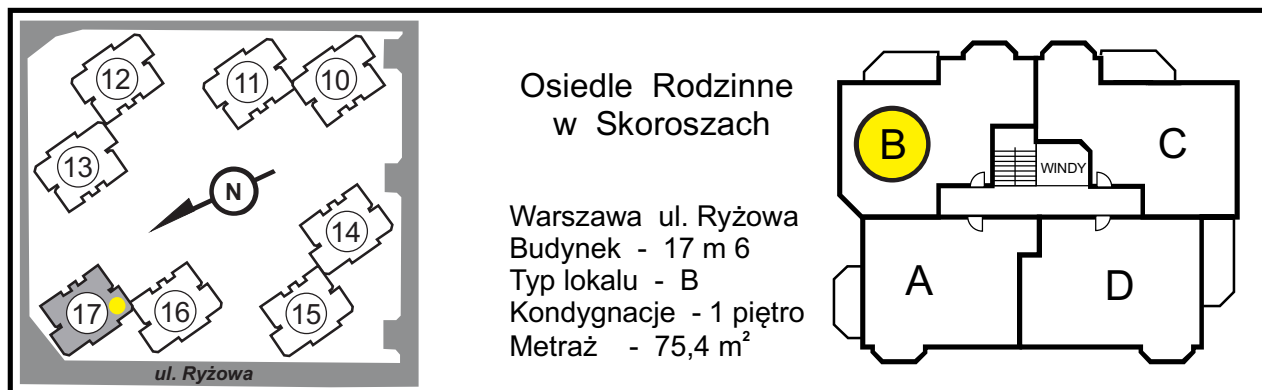

## Osiedle Rodzinne w Skoroszach

Warszawa ul. Ryżowa  
Budynek - 17 m 6  
Typ lokalu - B  
Kondygnacje - 1 piętro  
Metraż - 75,4 m<sup>2</sup>

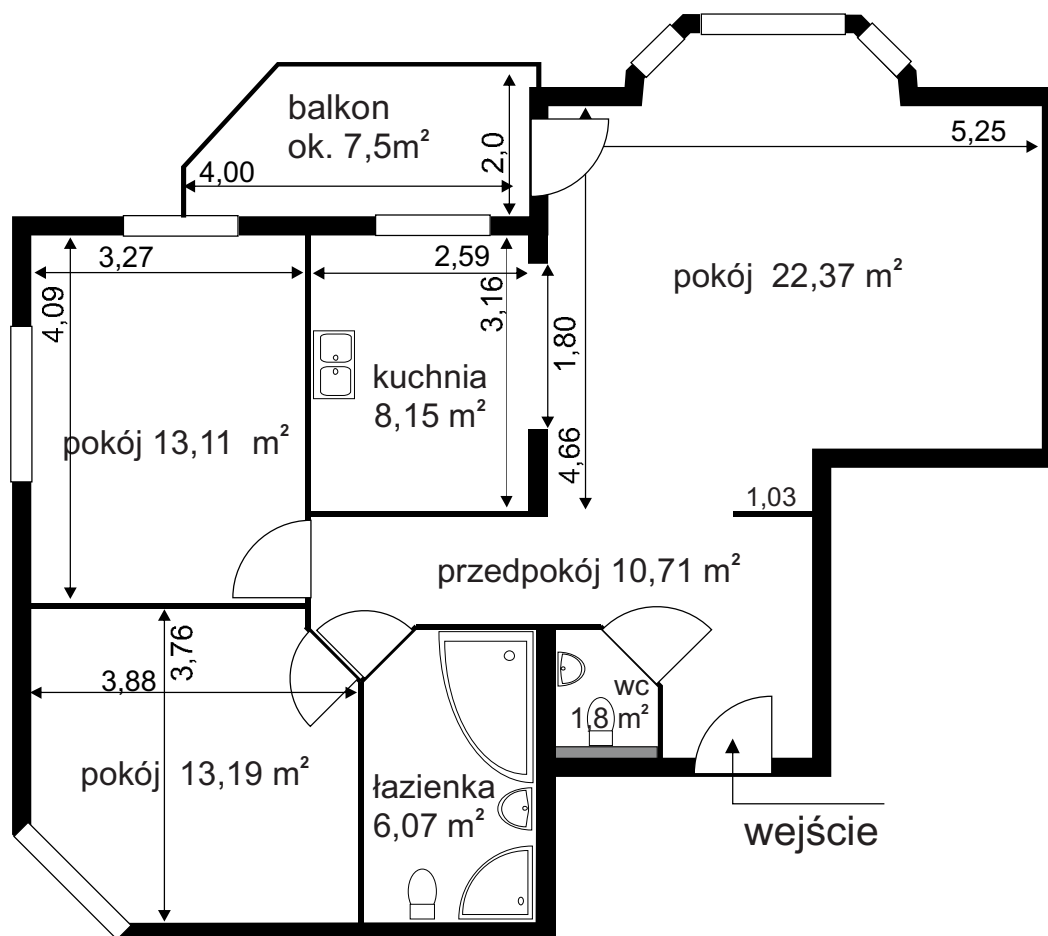

# OLMONT INVESTMENS Sp. z o.o.

ul. Ryżowa 41 02-495 Warszawa tel. (22) 867 54 37, 867 59 16 kom. 604 222 622

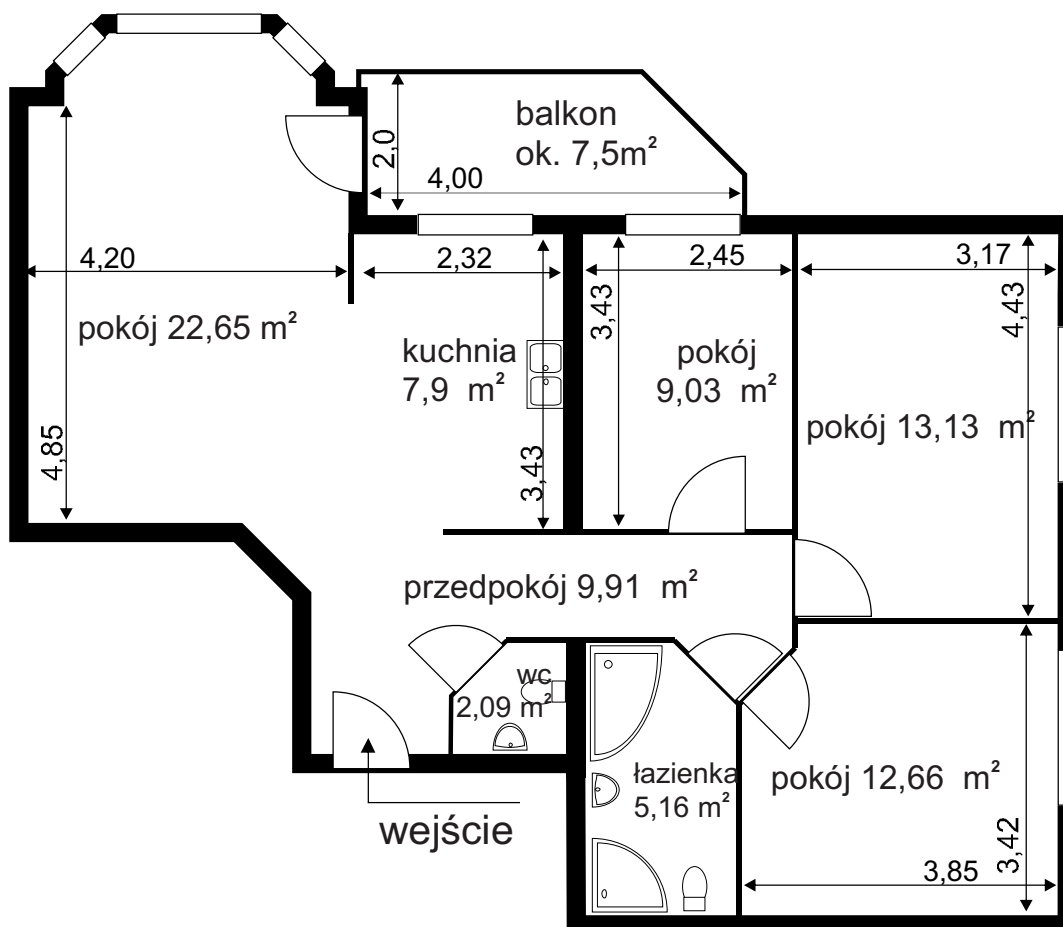
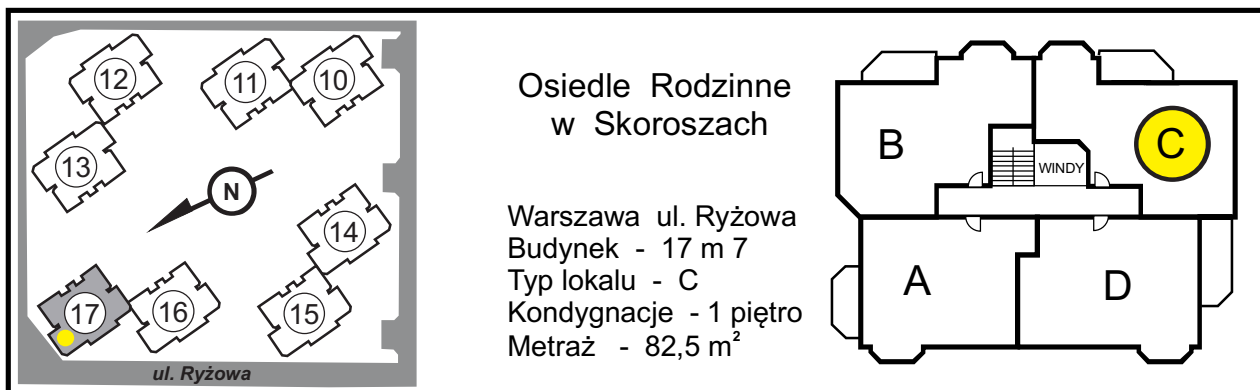

# OLMONT INVESTMENS Sp. z o.o.

ul. Ryżowa 41 02-495 Warszawa tel. (22) 867 54 37, 867 59 16 kom. 604 222 622

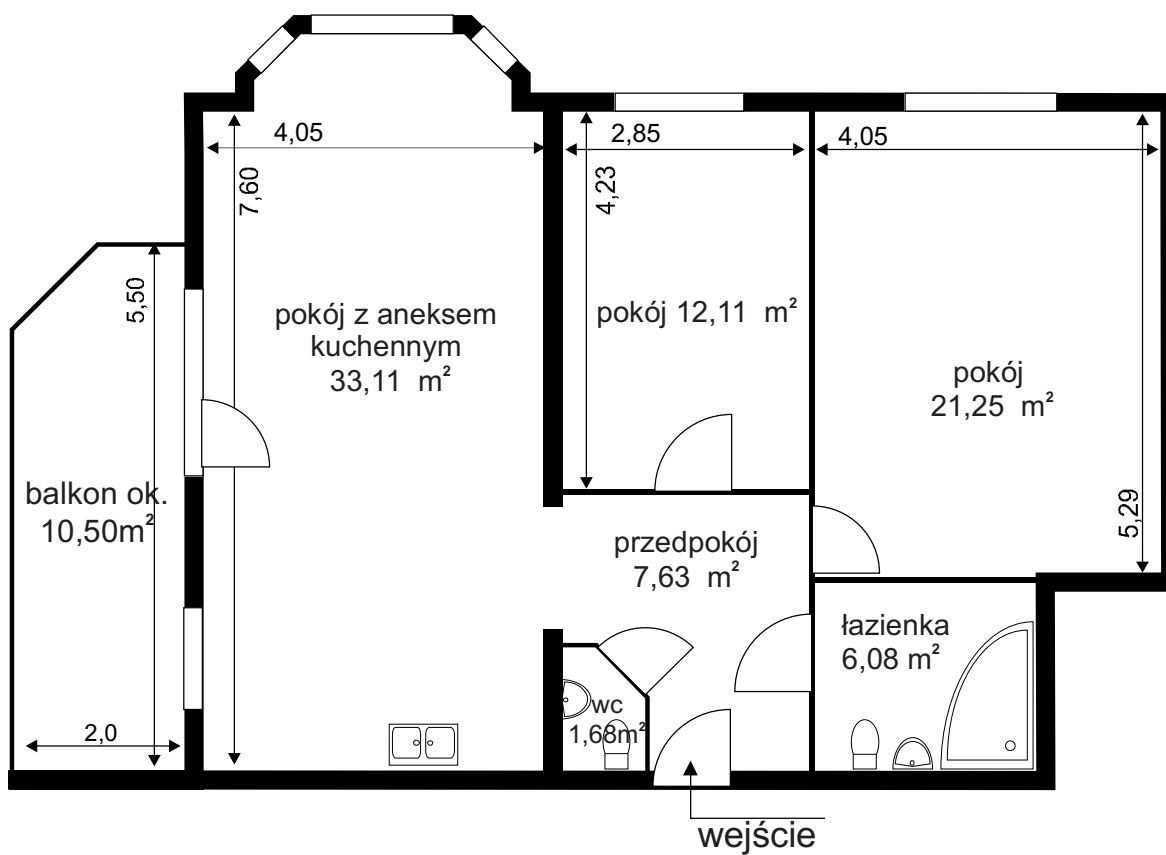
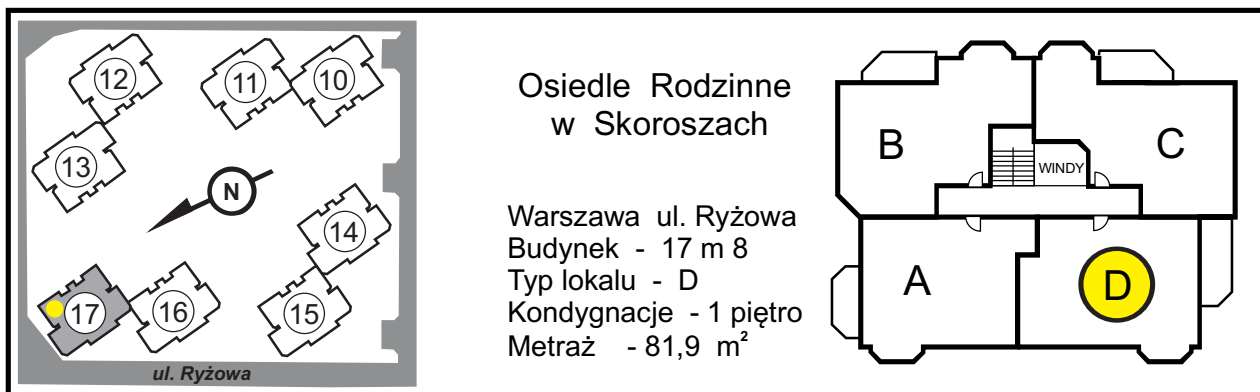

# OLMONT INVESTMENS Sp. z o.o.

ul. Ryżowa 41 02-495 Warszawa tel. (22) 867 54 37, 867 59 16 kom. 604 222 622

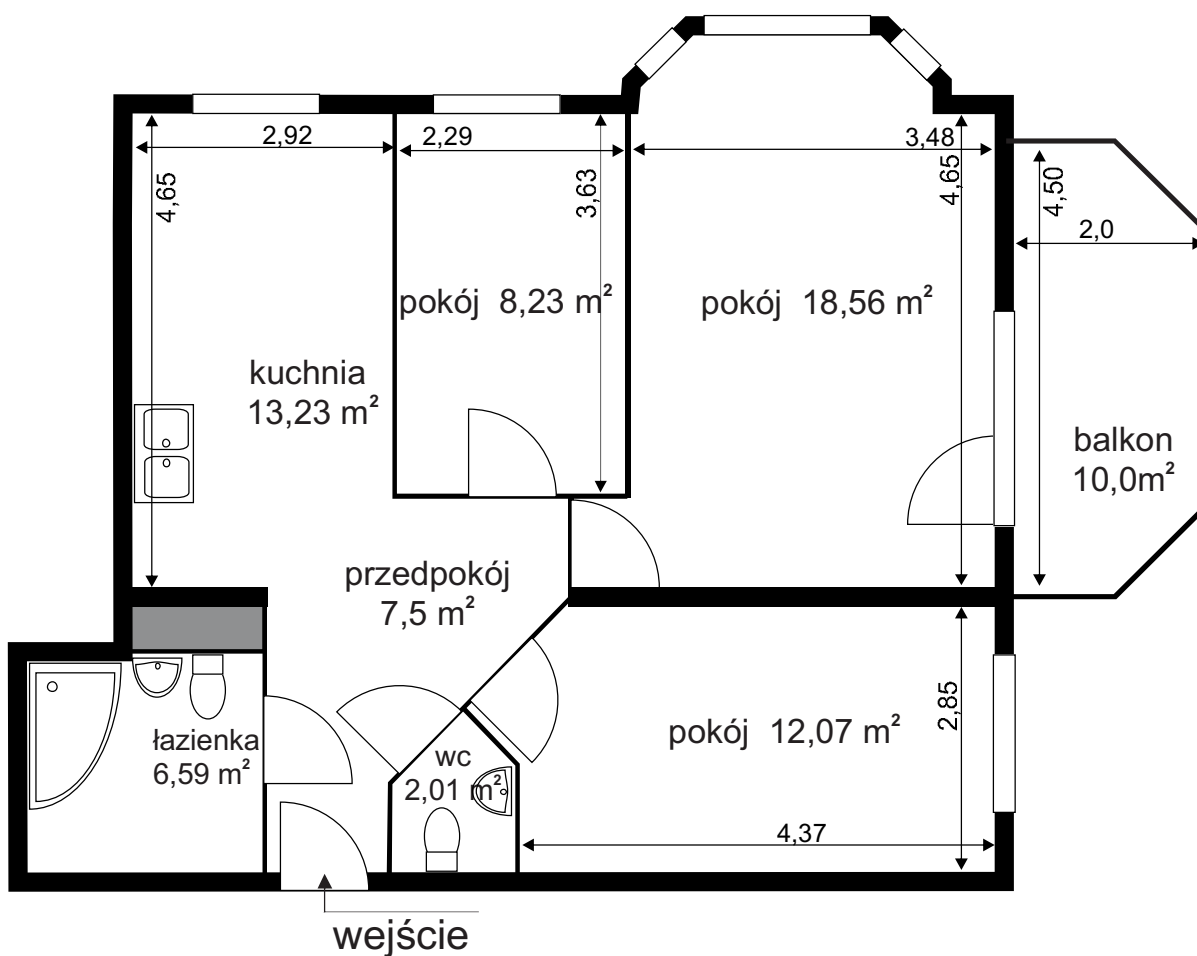
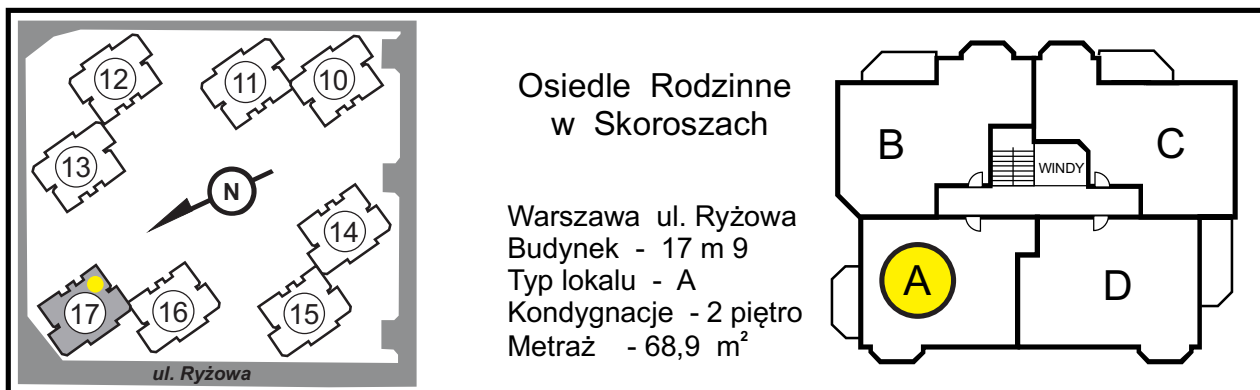

# OLMONT INVESTMENS Sp. z o.o.

ul. Ryżowa 41 02-495 Warszawa tel. (22) 867 54 37, 867 59 16 kom. 604 222 622

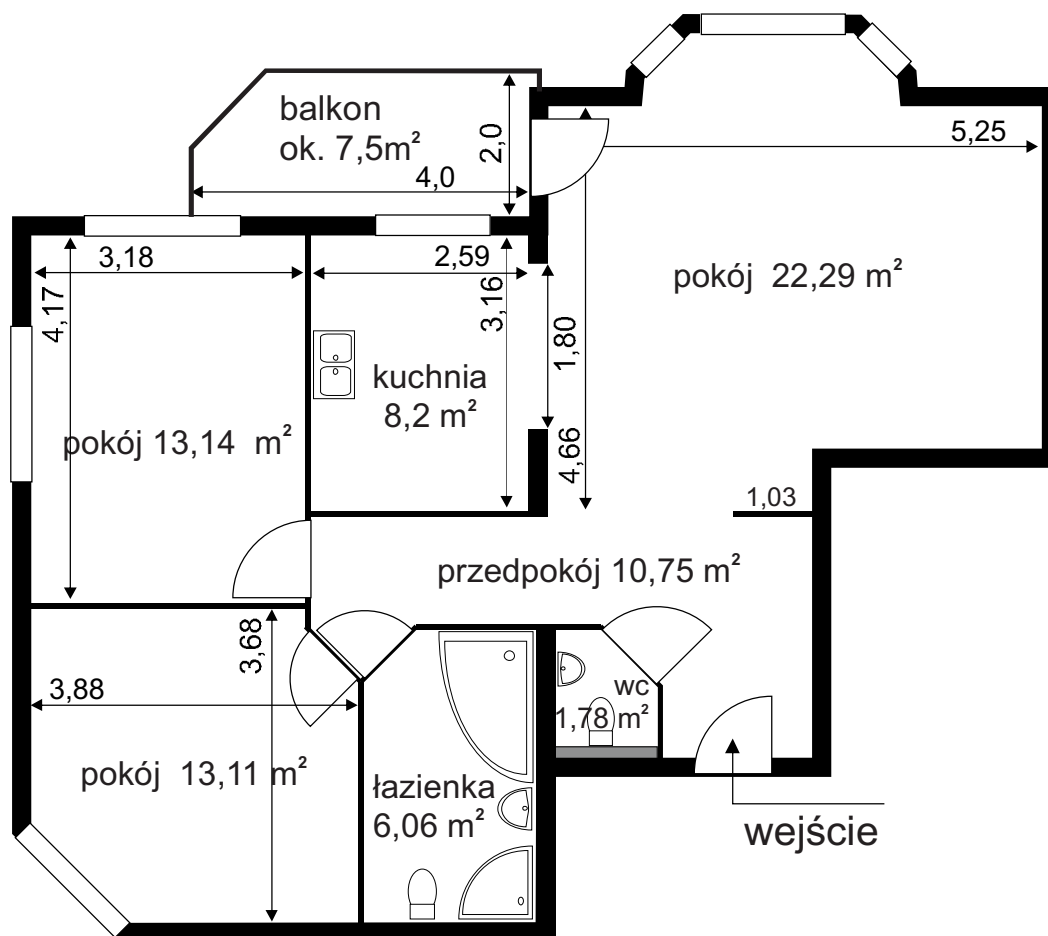
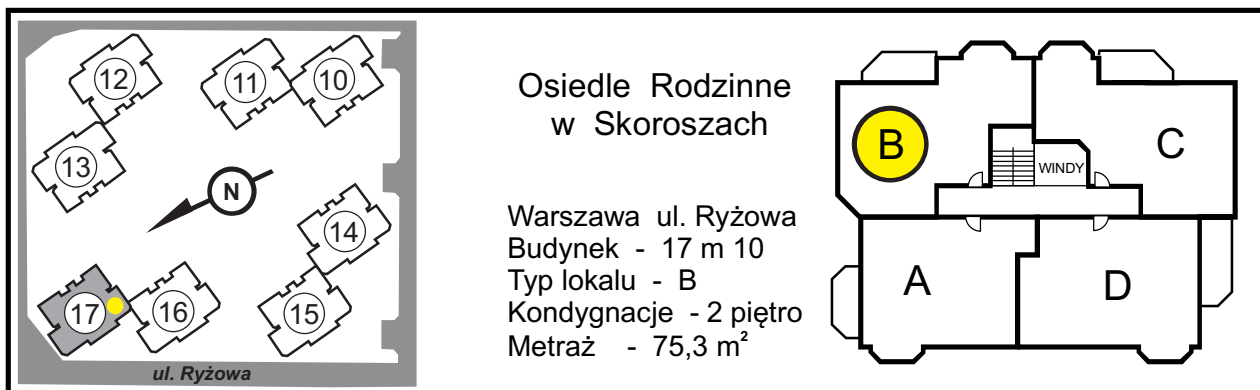

# OLMONT INVESTMENS Sp. z o.o.

ul. Ryżowa 41 02-495 Warszawa tel. (22) 867 54 37, 867 59 16 kom. 604 222 622

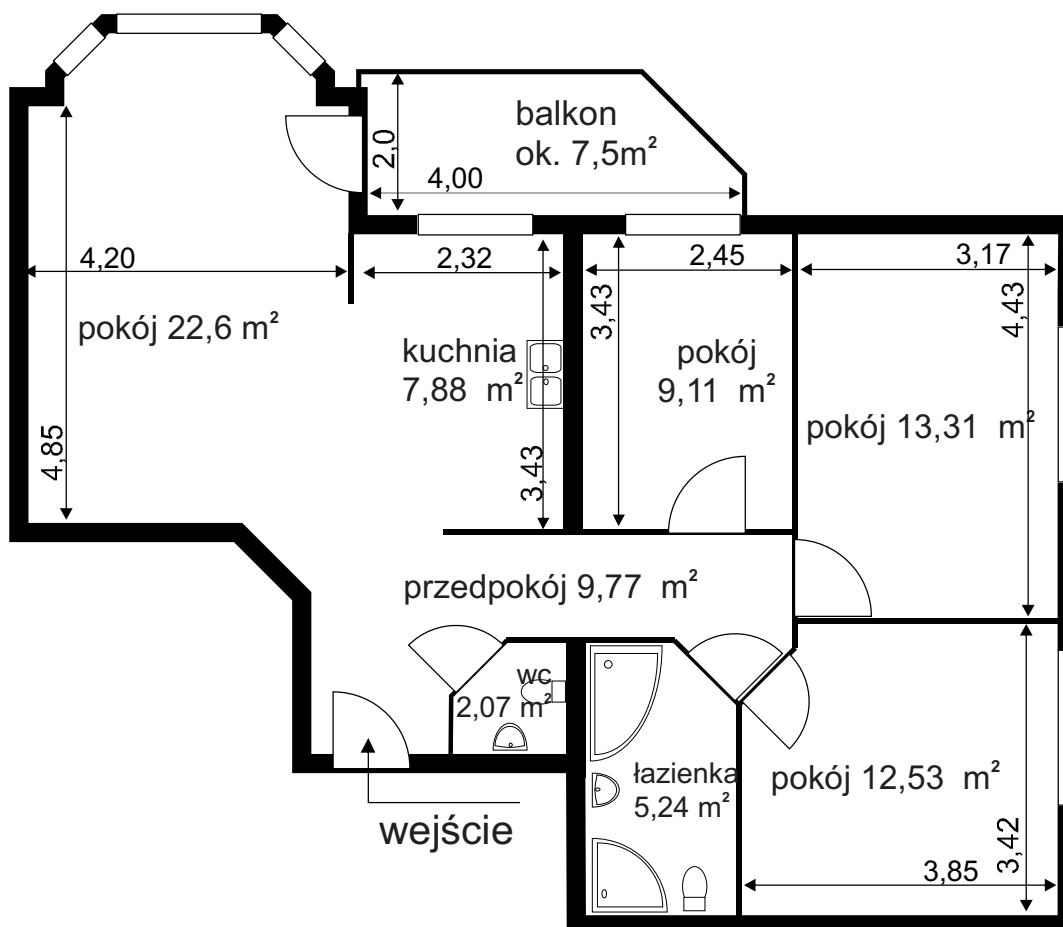
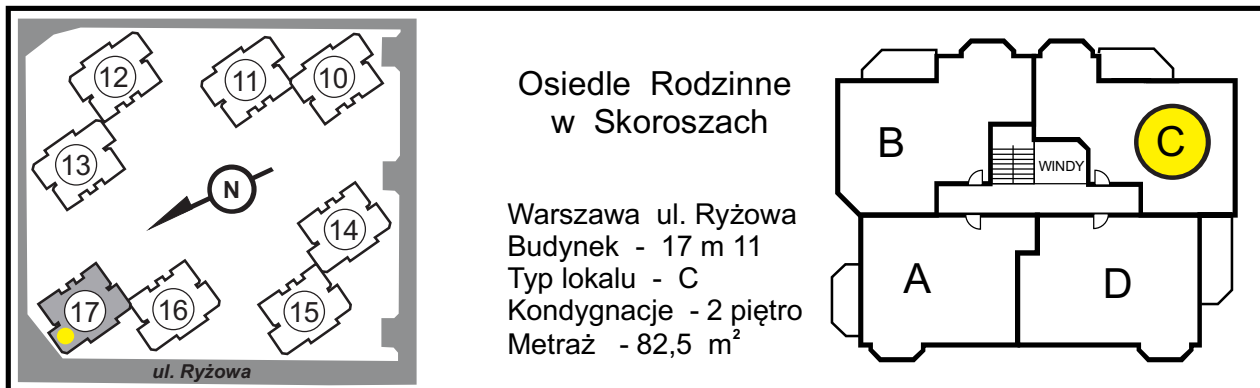

# OLMONT INVESTMENS Sp. z o.o.

ul. Ryżowa 41 02-495 Warszawa tel. (22) 867 54 37, 867 59 16 kom. 604 222 622

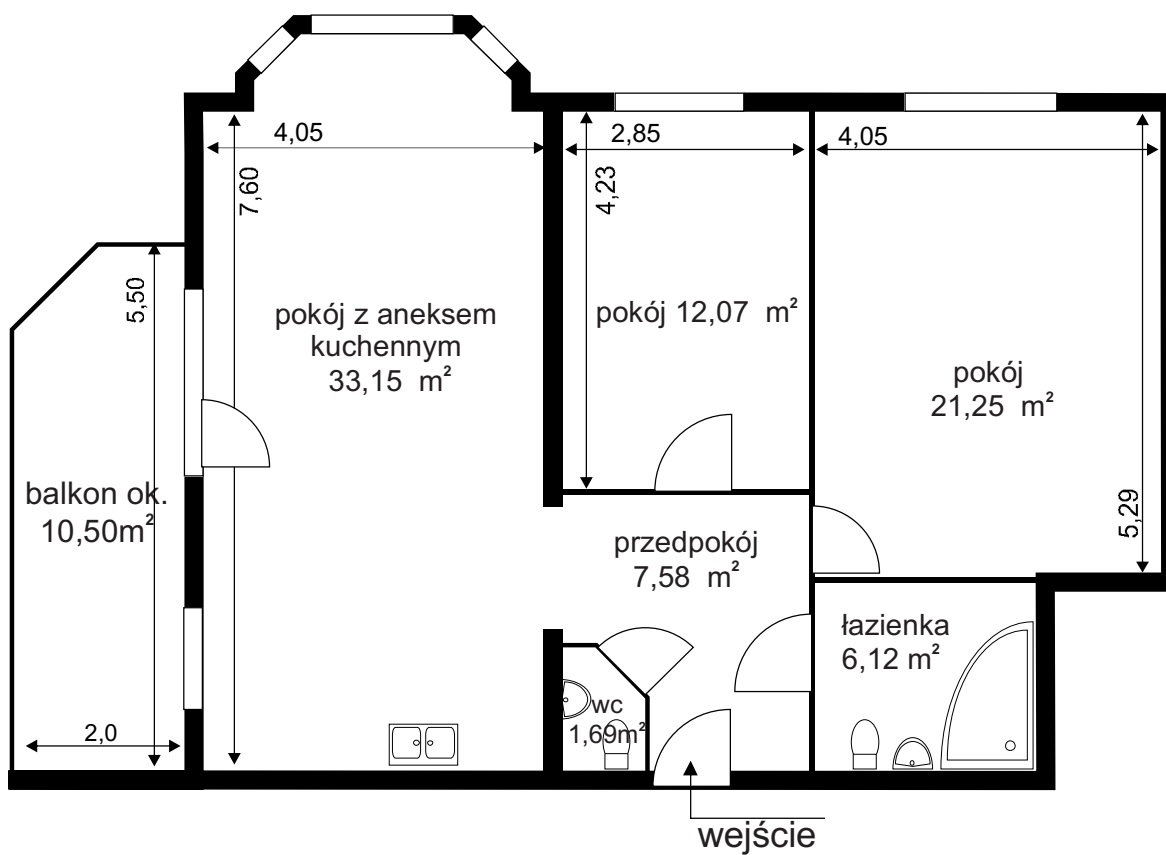
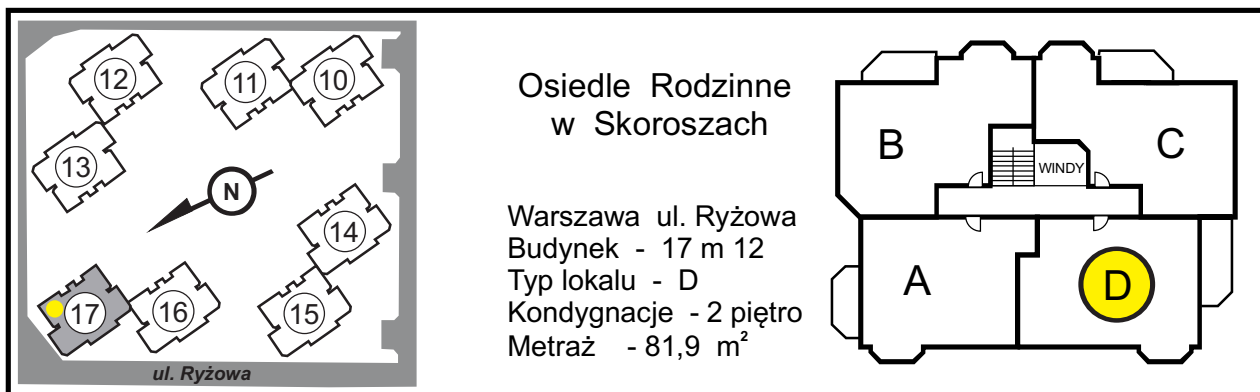

# OLMONT INVESTMENS Sp. z o.o.

ul. Ryżowa 41 02-495 Warszawa tel. (22) 867 54 37, 867 59 16 kom. 604 222 622

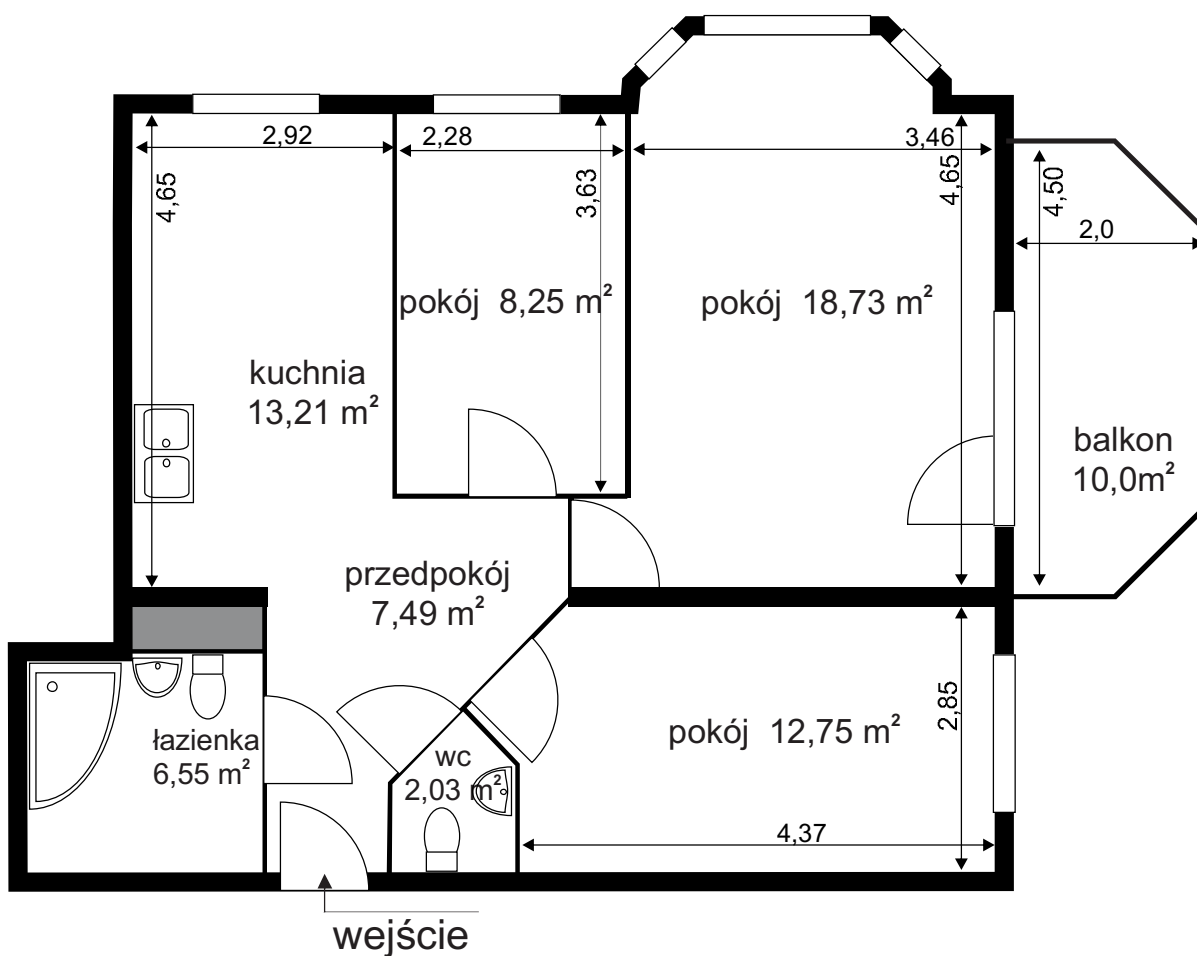
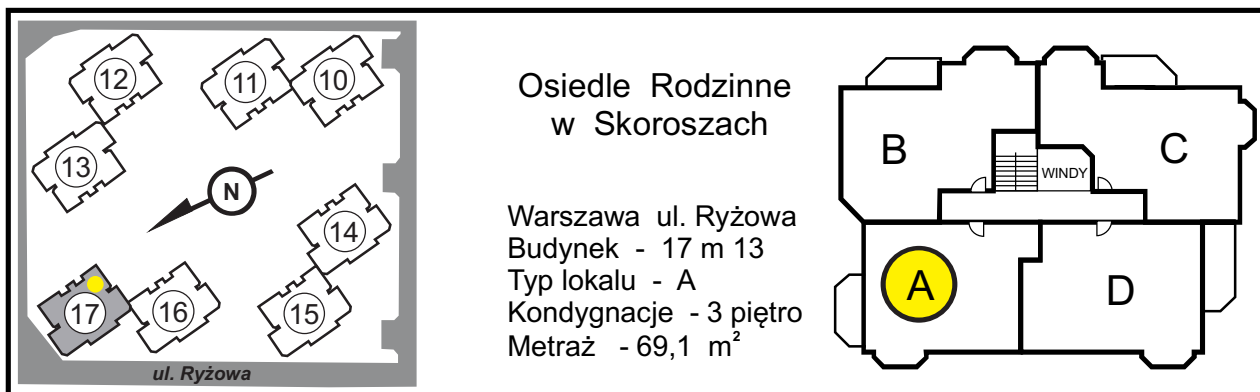

# OLMONT INVESTMENS Sp. z o.o.

ul. Ryżowa 41 02-495 Warszawa tel. (22) 867 54 37, 867 59 16 kom. 604 222 622

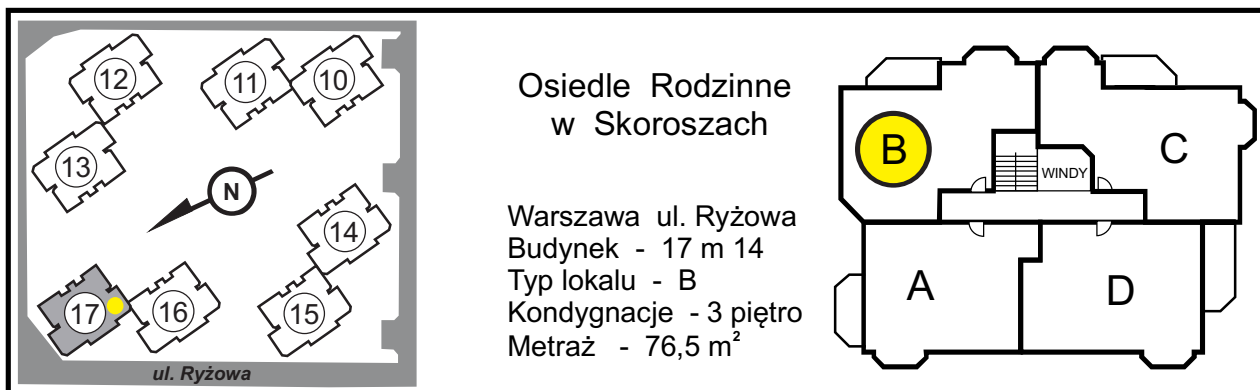

## Osiedle Rodzinne w Skoroszach

Warszawa ul. Ryżowa  
Budynek - 17 m 14  
Typ lokalu - B  
Kondygnacje - 3 piętro  
Metraż - 76,5 m<sup>2</sup>

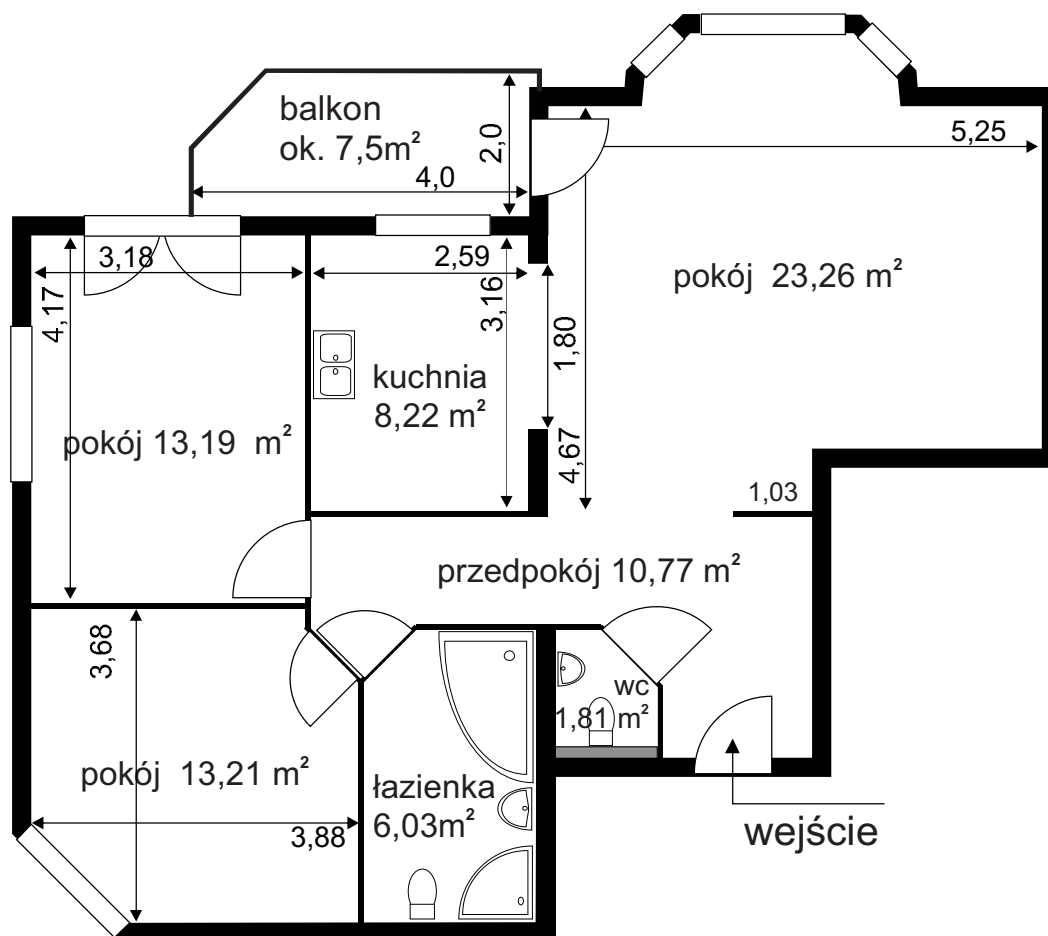

# OLMONT INVESTMENS Sp. z o.o.

ul. Ryżowa 41 02-495 Warszawa tel. (22) 867 54 37, 867 59 16 kom. 604 222 622

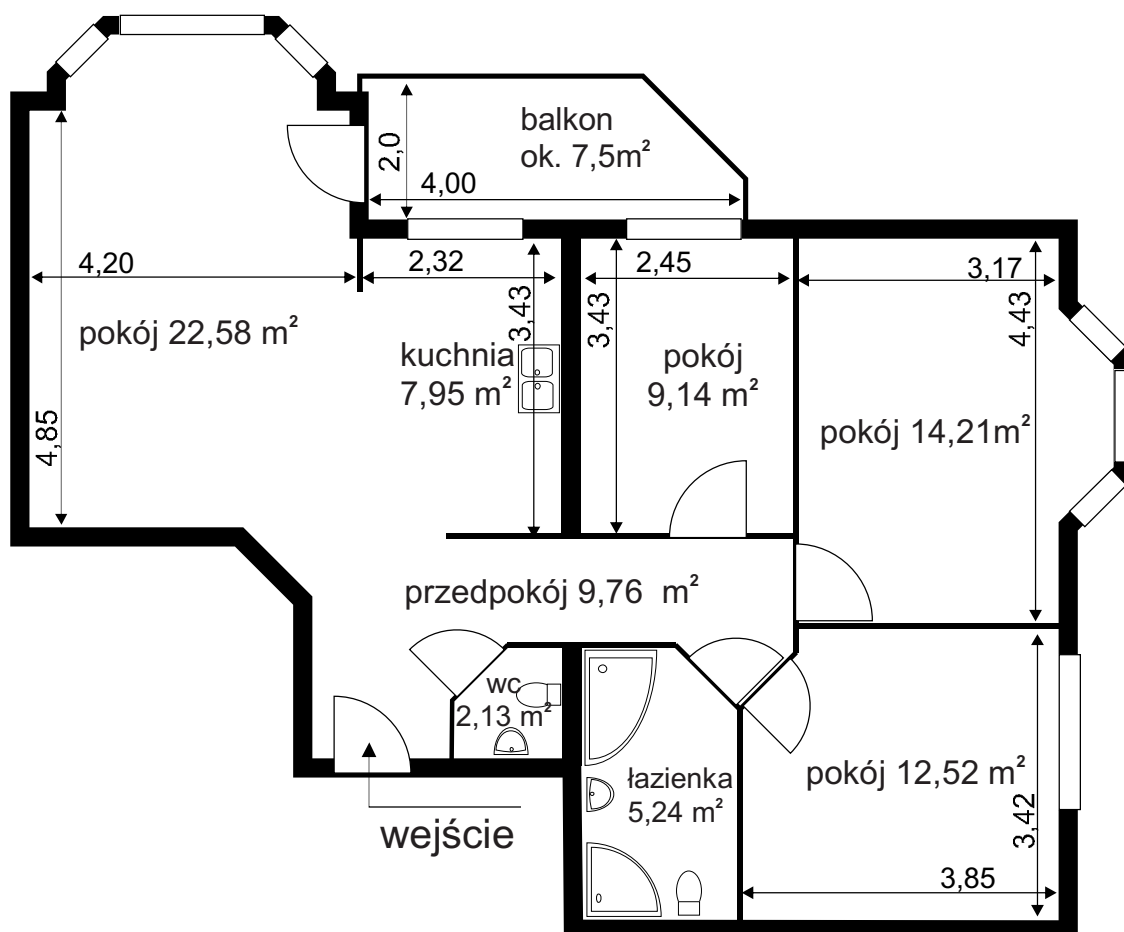
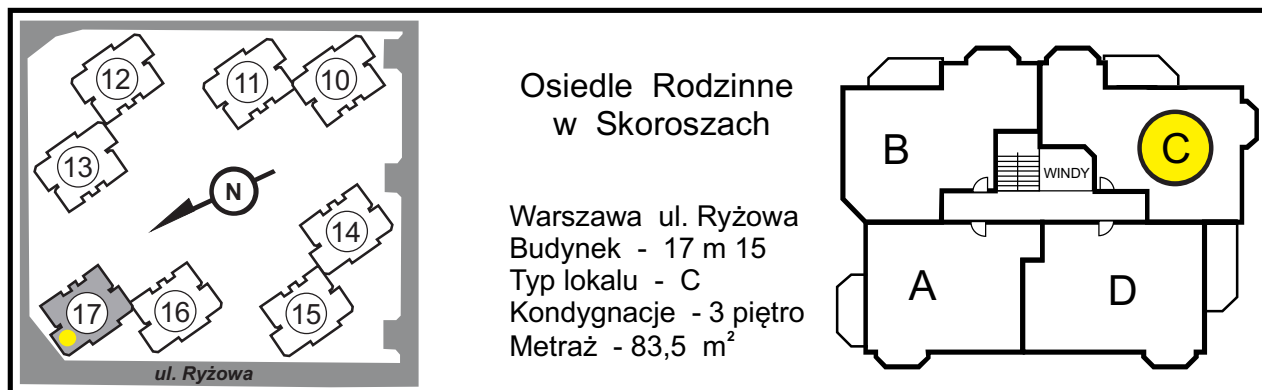

# OLMONT INVESTMENS Sp. z o.o.

ul. Ryżowa 41 02-495 Warszawa tel. (22) 867 54 37, 867 59 16 kom. 604 222 622

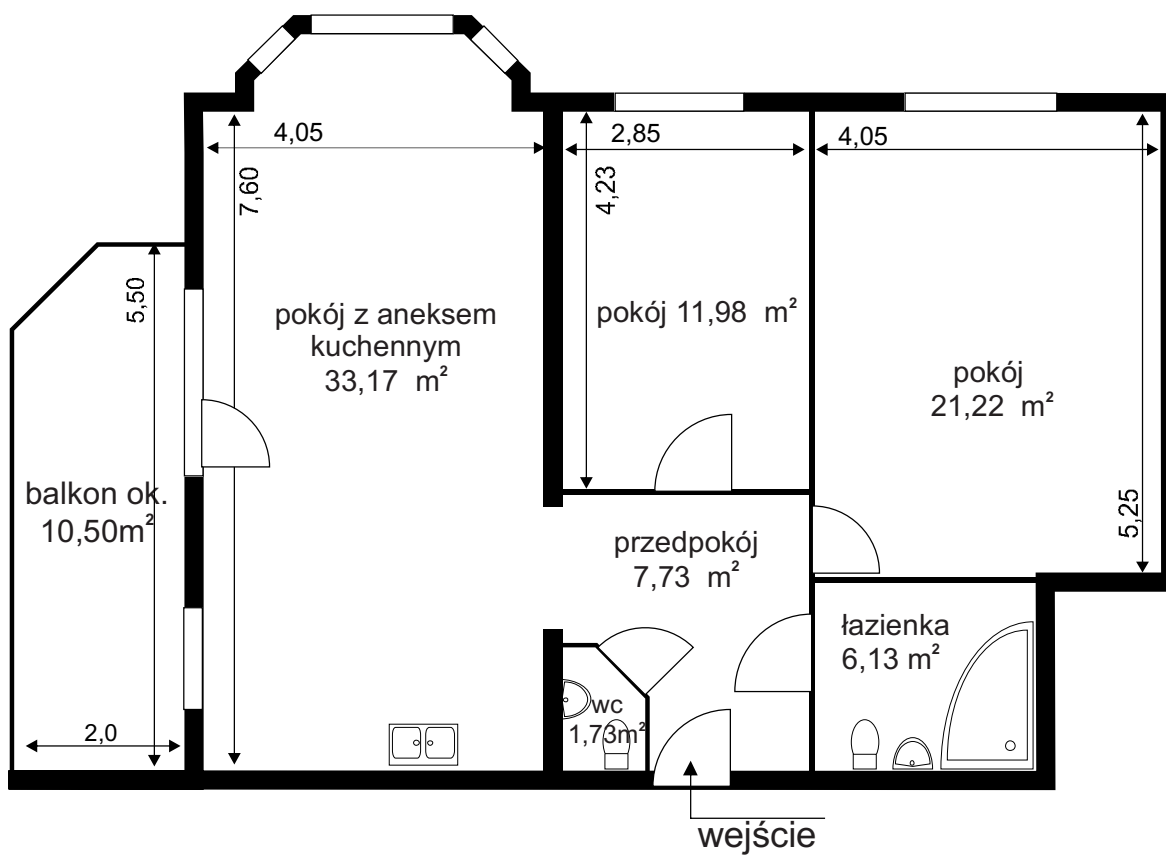
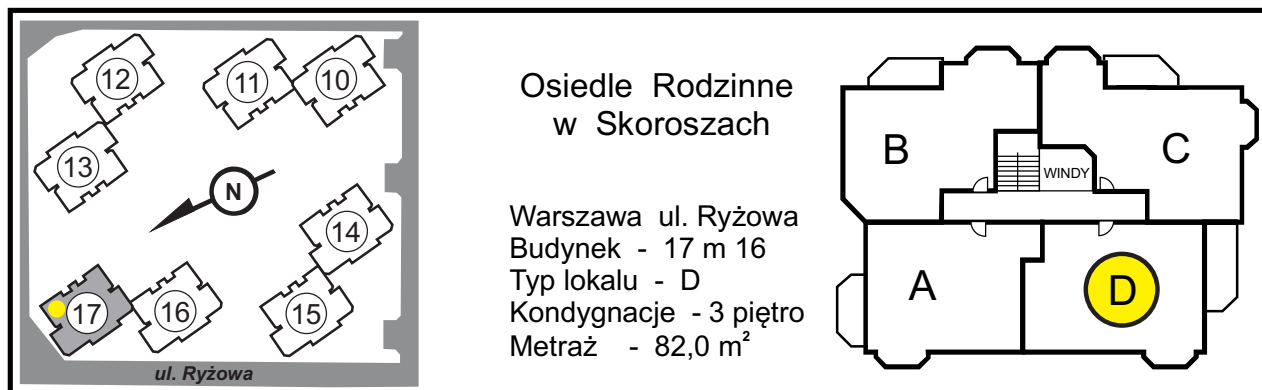

# OLMONT INVESTMENS Sp. z o.o.

ul. Ryżowa 41 02-495 Warszawa tel. (22) 867 54 37, 867 59 16 kom. 604 222 622

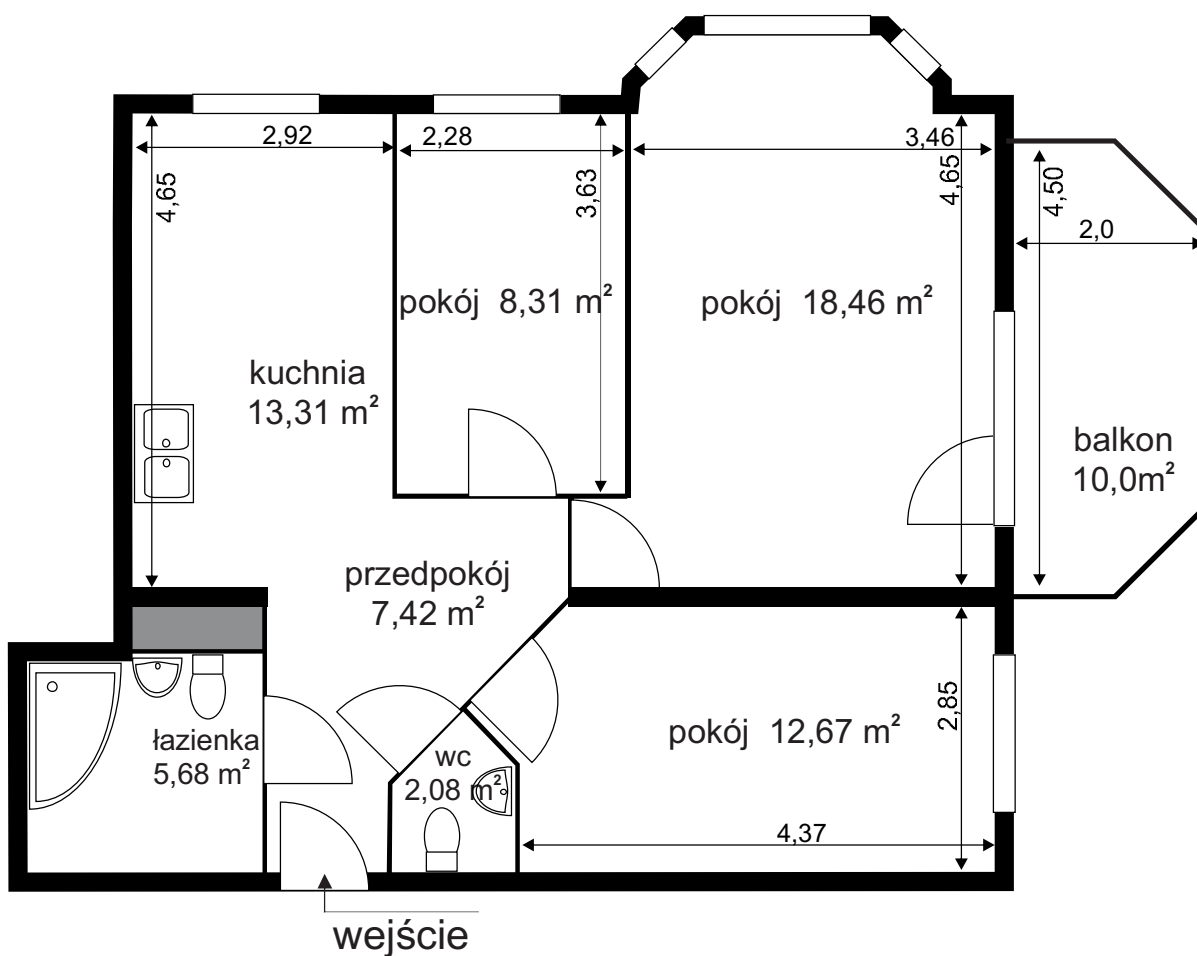
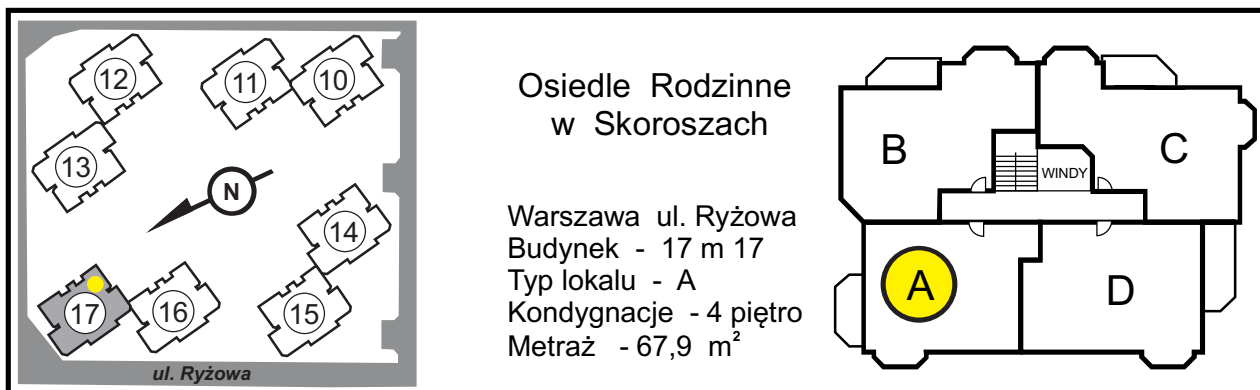

# OLMONT INVESTMENS Sp. z o.o.

ul. Ryżowa 41 02-495 Warszawa tel. (22) 867 54 37, 867 59 16 kom. 604 222 622

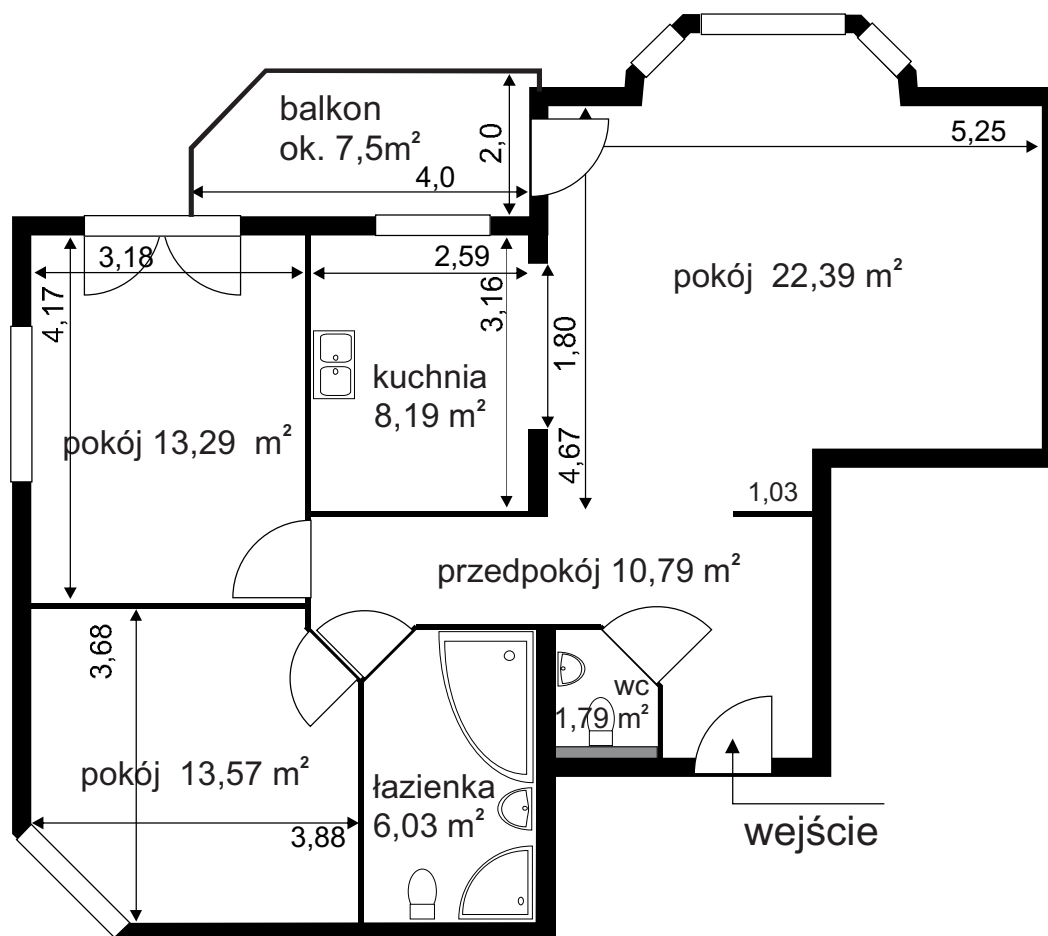
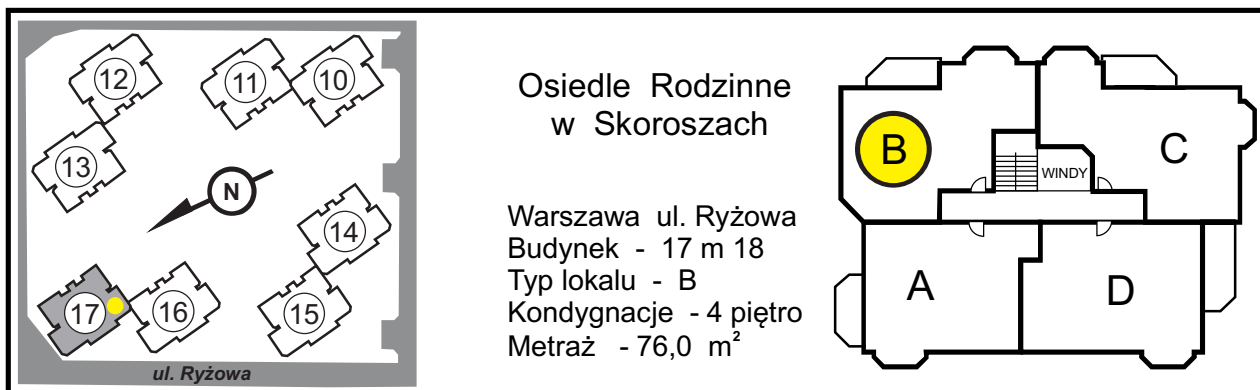

# OLMONT INVESTMENS Sp. z o.o.

ul. Ryżowa 41 02-495 Warszawa tel. (22) 867 54 37, 867 59 16 kom. 604 222 622

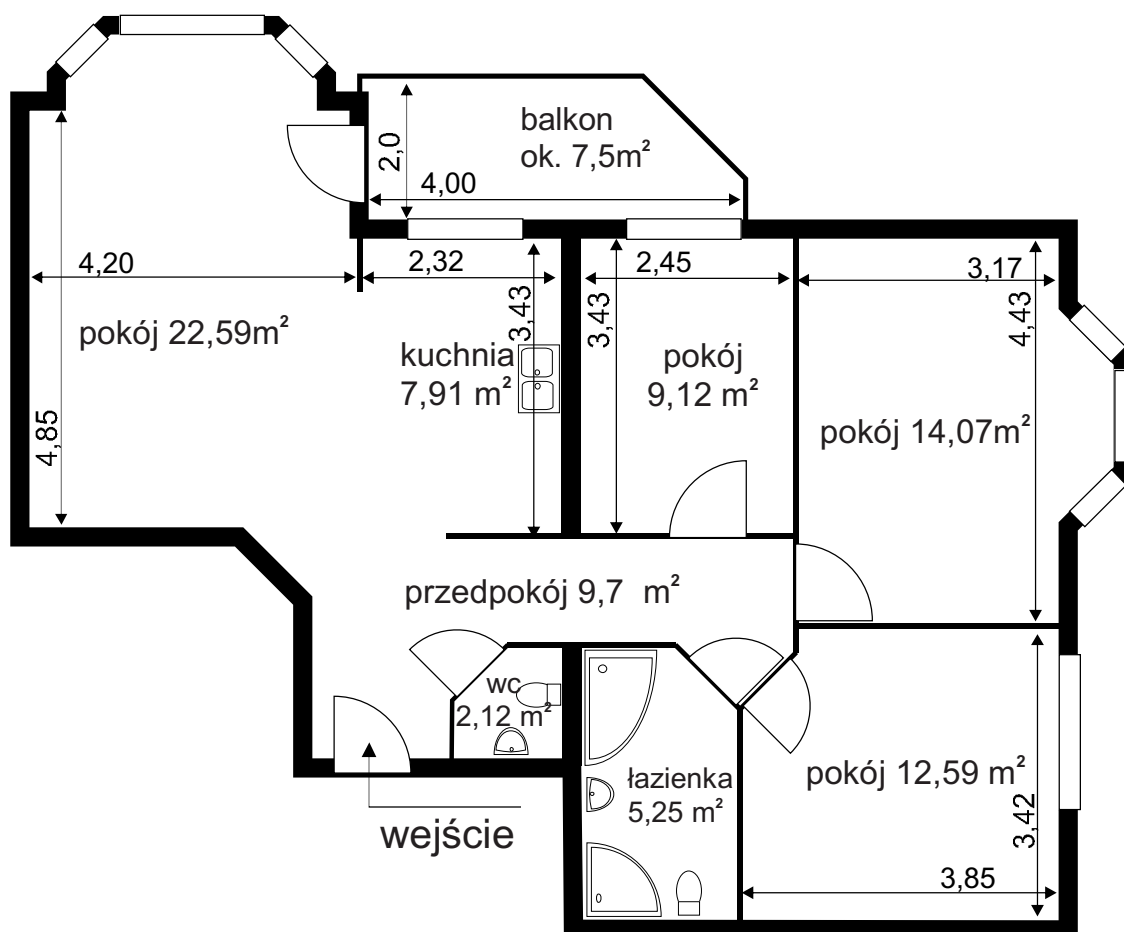
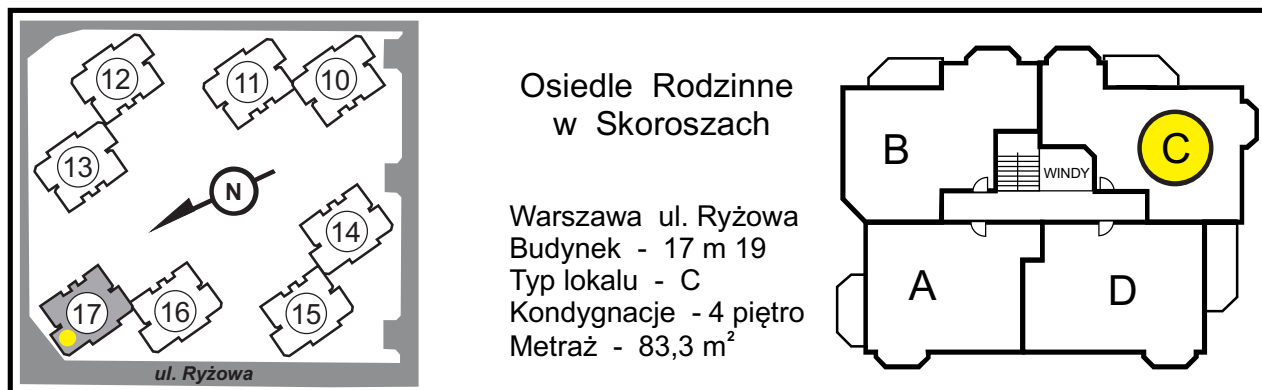

# OLMONT INVESTMENS Sp. z o.o.

ul. Ryżowa 41 02-495 Warszawa tel. (22) 867 54 37, 867 59 16 kom. 604 222 622

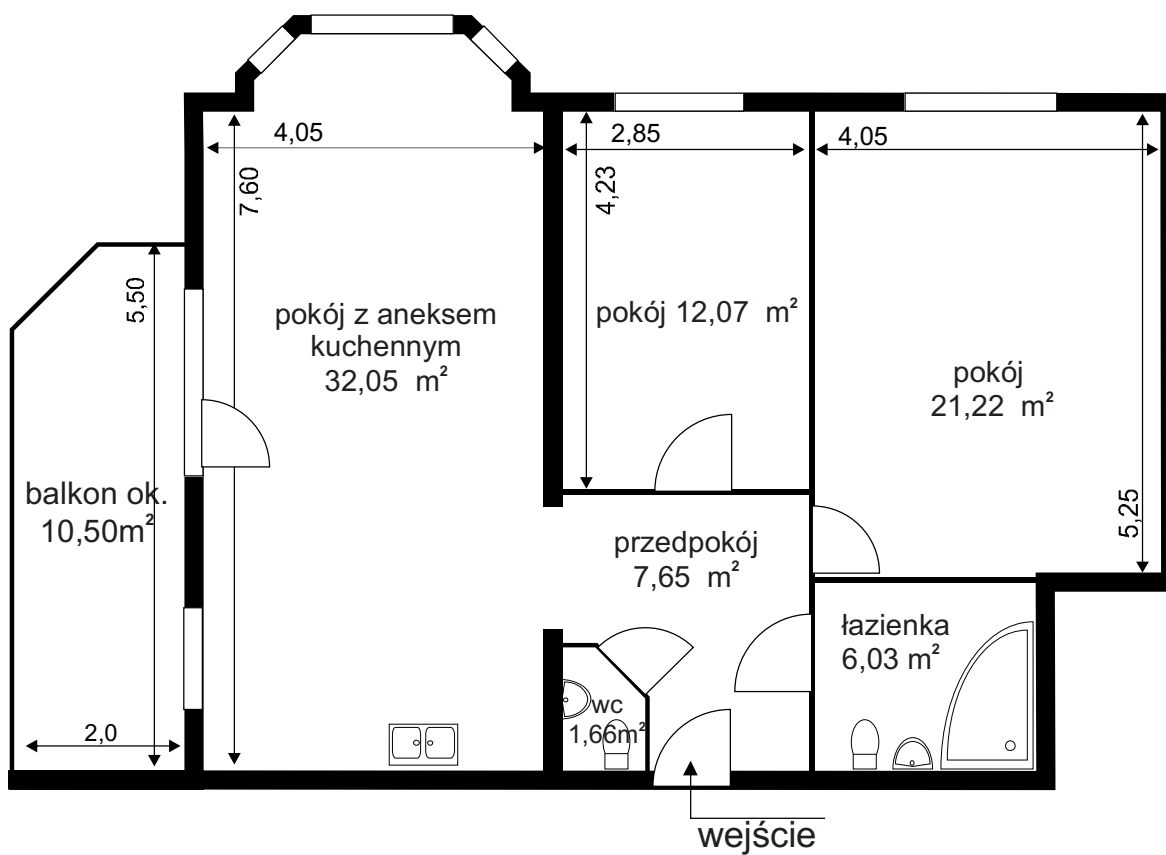
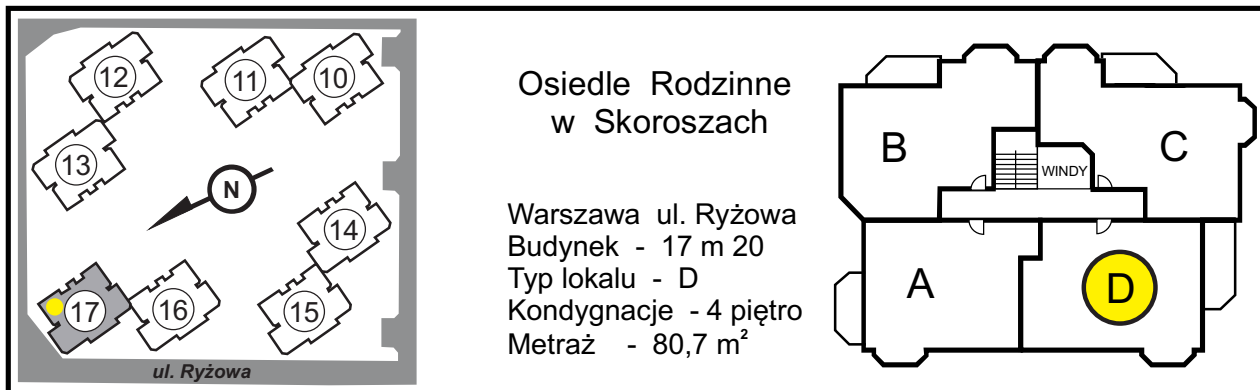

# OLMONT INVESTMENS Sp. z o.o.

ul. Ryżowa 41 02-495 Warszawa tel. (22) 867 54 37, 867 59 16 kom. 604 222 622

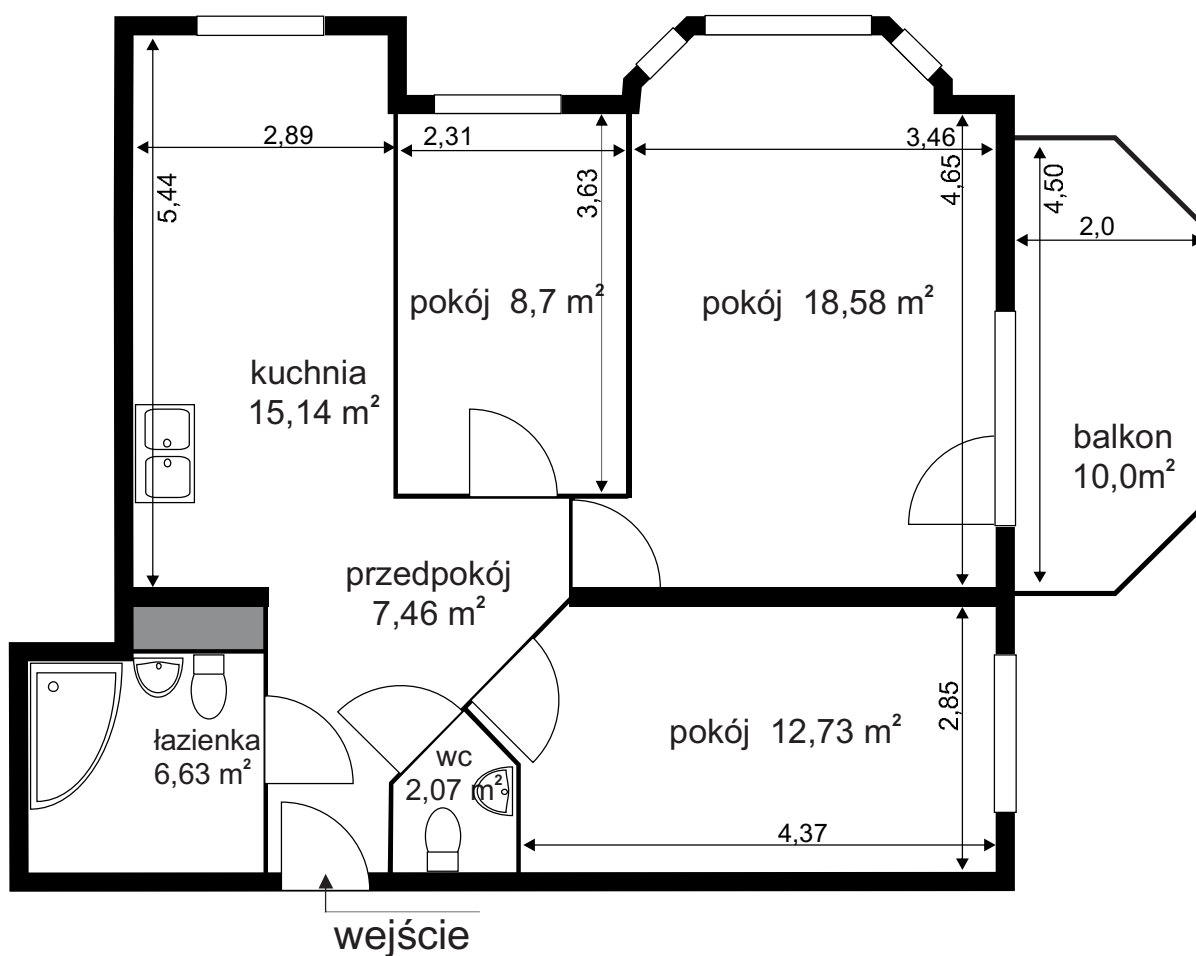
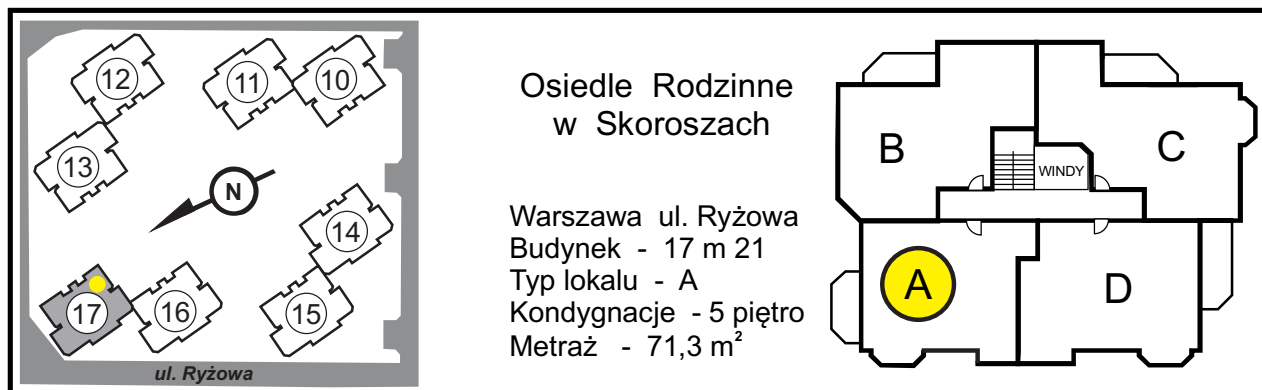

# OLMONT INVESTMENS Sp. z o.o.

ul. Ryżowa 41 02-495 Warszawa tel. (22) 867 54 37, 867 59 16 kom. 604 222 622

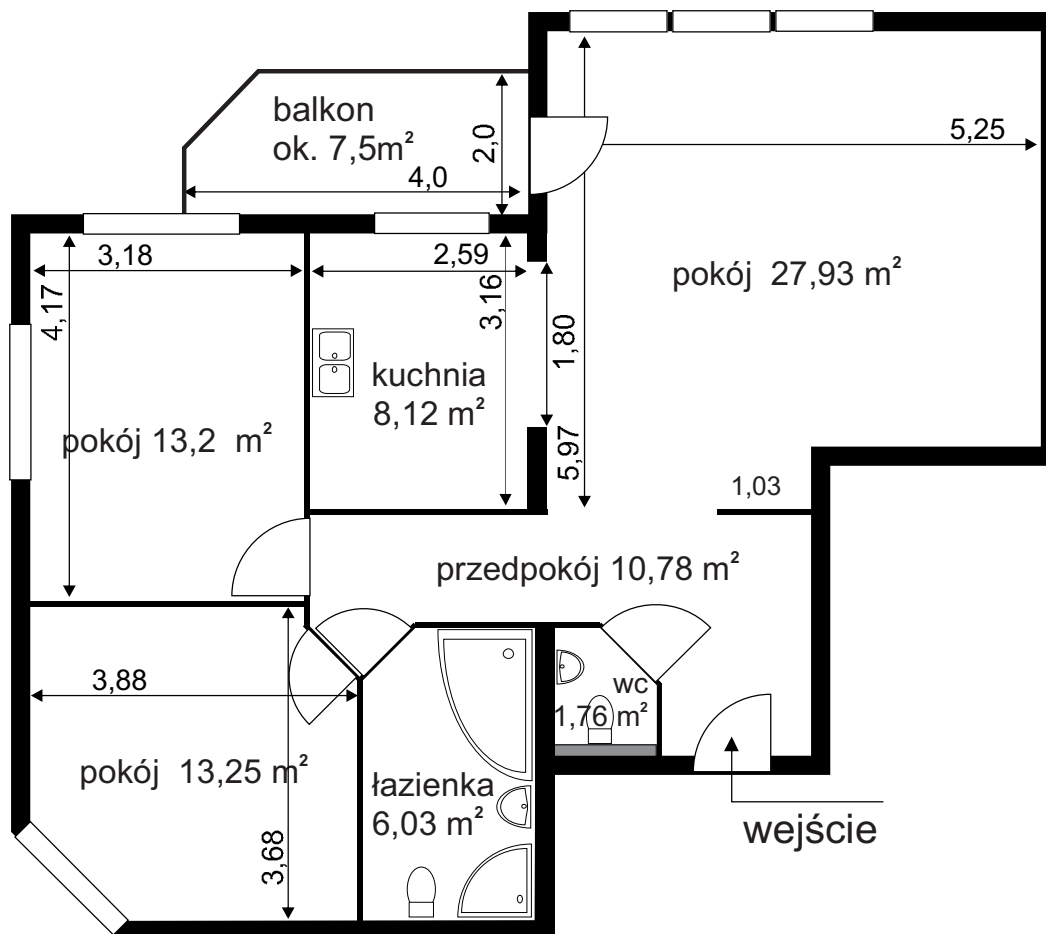
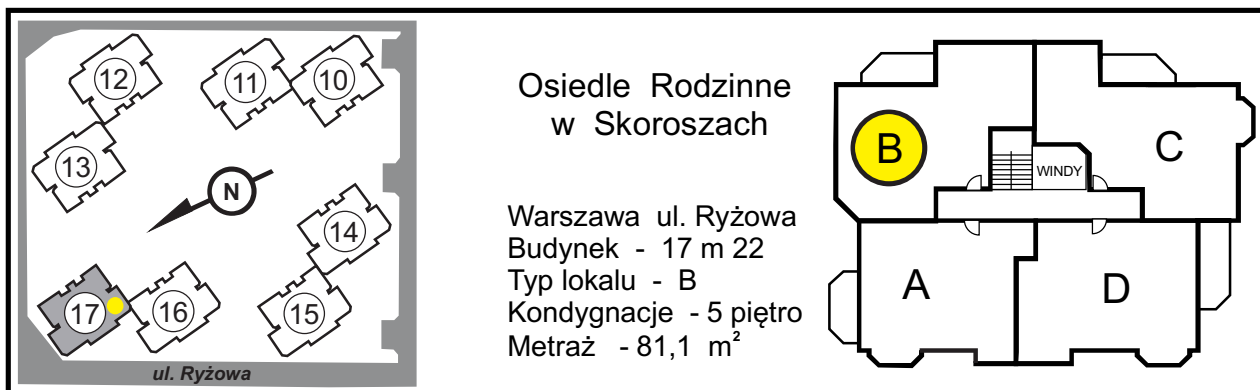

# OLMONT INVESTMENS Sp. z o.o.

ul. Ryżowa 41 02-495 Warszawa tel. (22) 867 54 37, 867 59 16 kom. 604 222 622

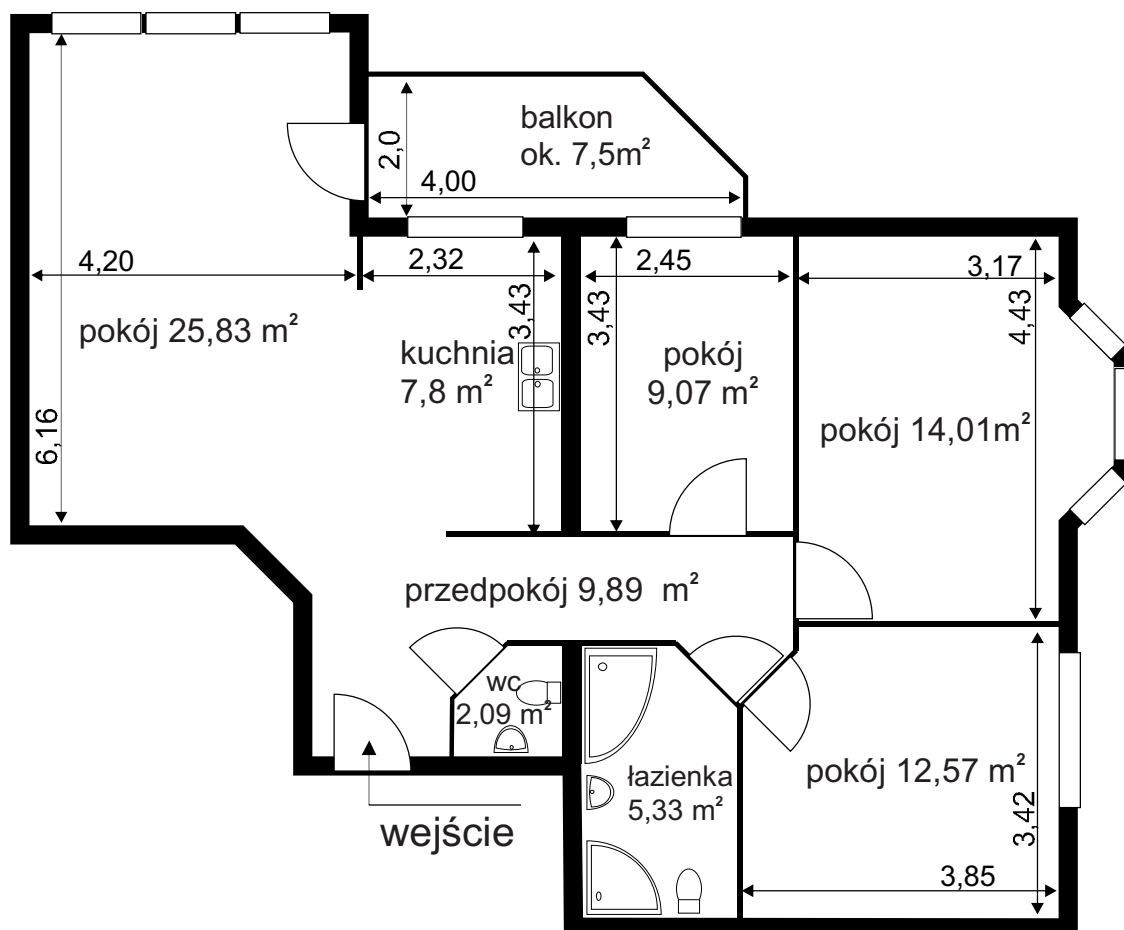
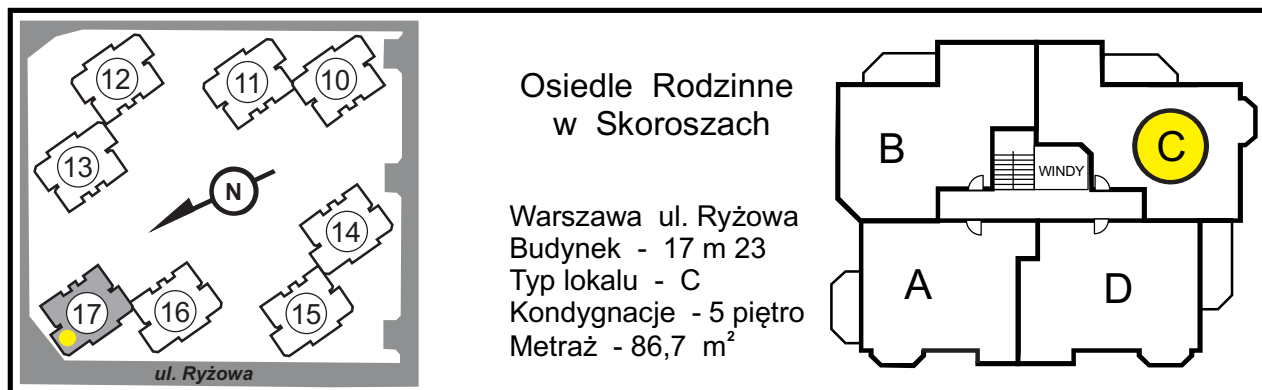

# OLMONT INVESTMENS Sp. z o.o.

ul. Ryżowa 41 02-495 Warszawa tel. (22) 867 54 37, 867 59 16 kom. 604 222 622

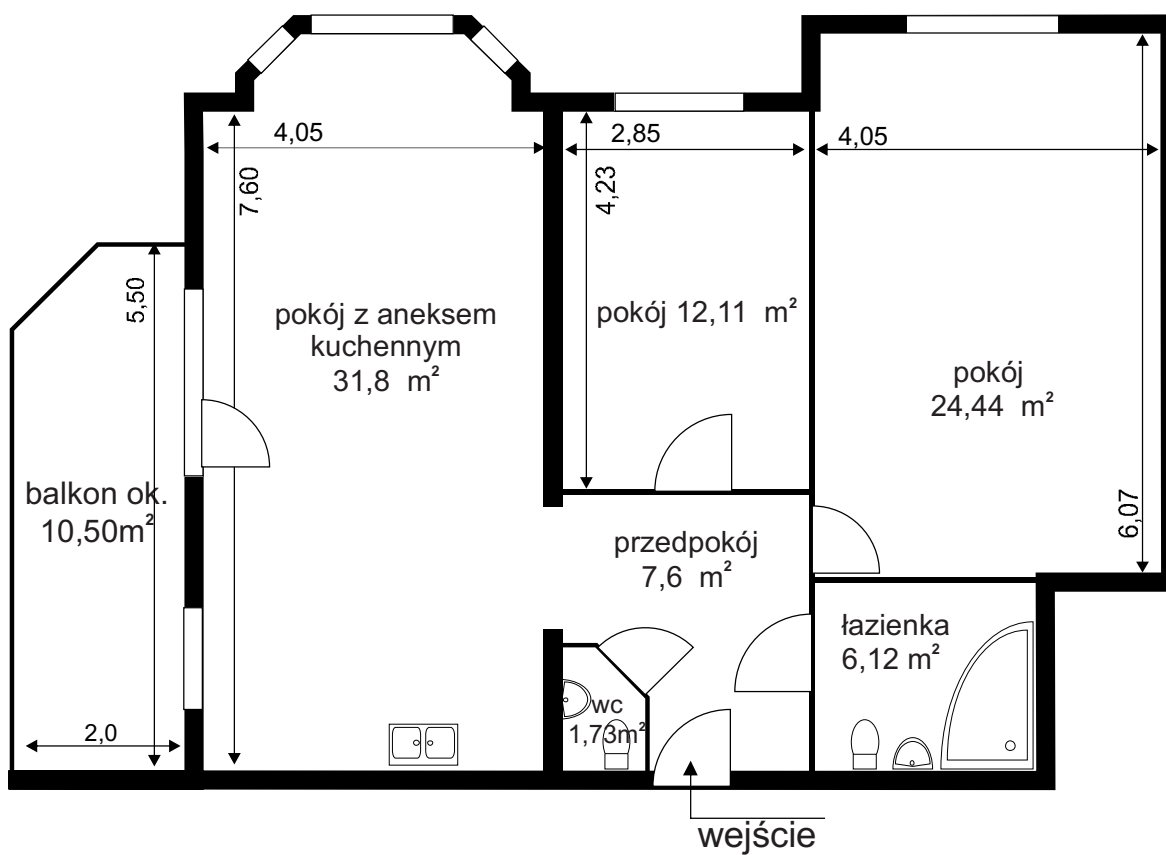
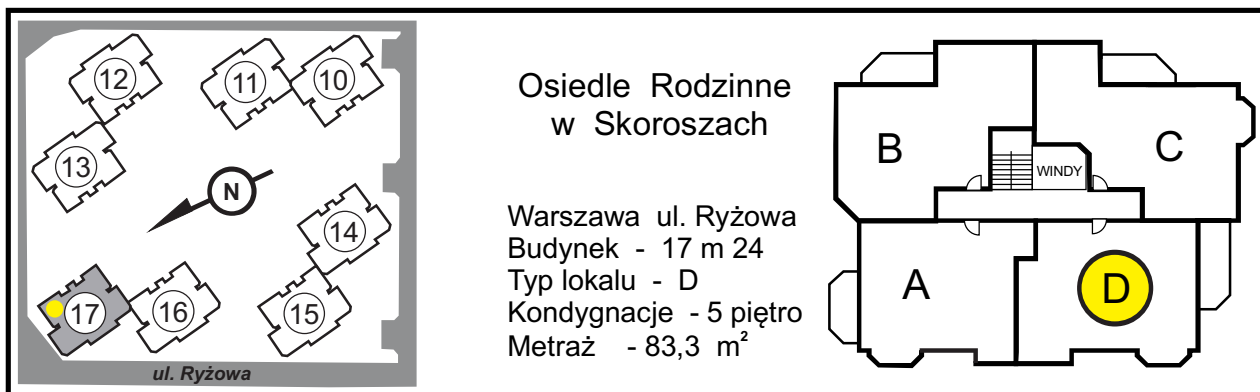

# OLMONT INVESTMENS Sp. z o.o.

ul. Ryżowa 41 02-495 Warszawa tel. (22) 867 54 37, 867 59 16 kom. 604 222 622

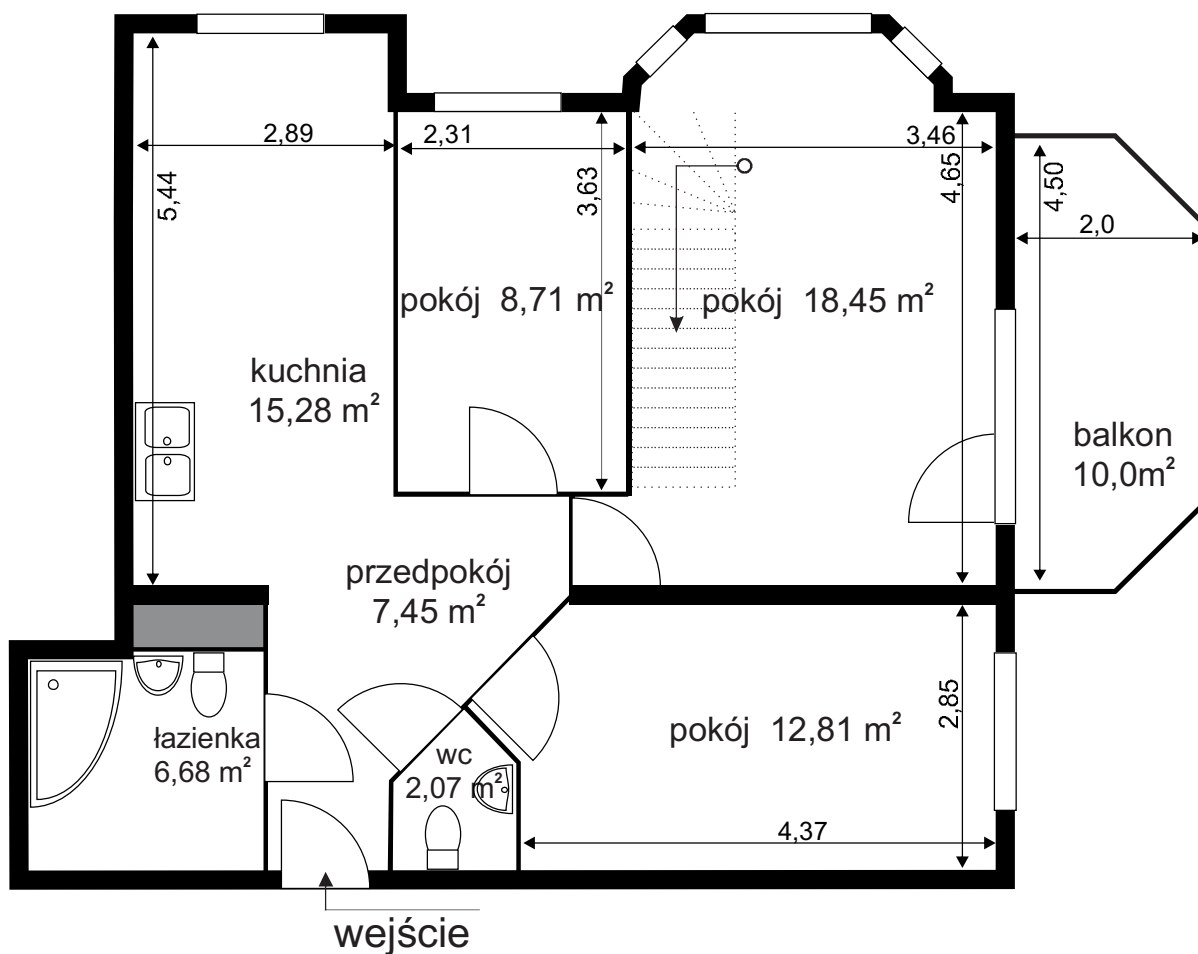
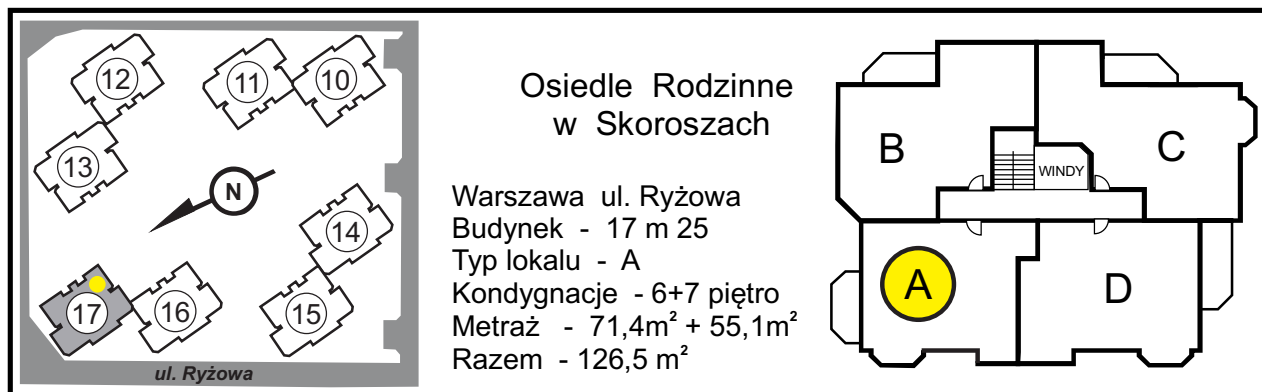

# OLMONT INVESTMENS Sp. z o.o.

ul. Ryżowa 41 02-495 Warszawa tel. (22) 867 54 37, 867 59 16 kom. 604 222 622

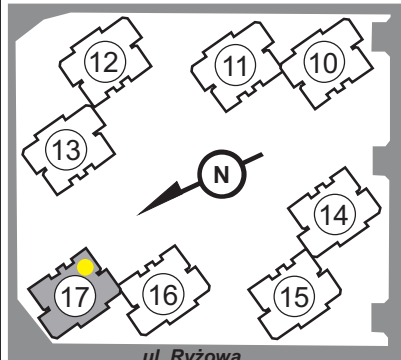

Osiedle Rodzinne  
w Skoroszach

Warszawa ul. Ryżowa  
Budynek - 17 m 25  
Typ lokalu - A poddasze  
Kondygnacje - 6+7 piętro  
Metraż - 71,4m<sup>2</sup> + 55,1m<sup>2</sup>  
Razem - 126,5 m<sup>2</sup>

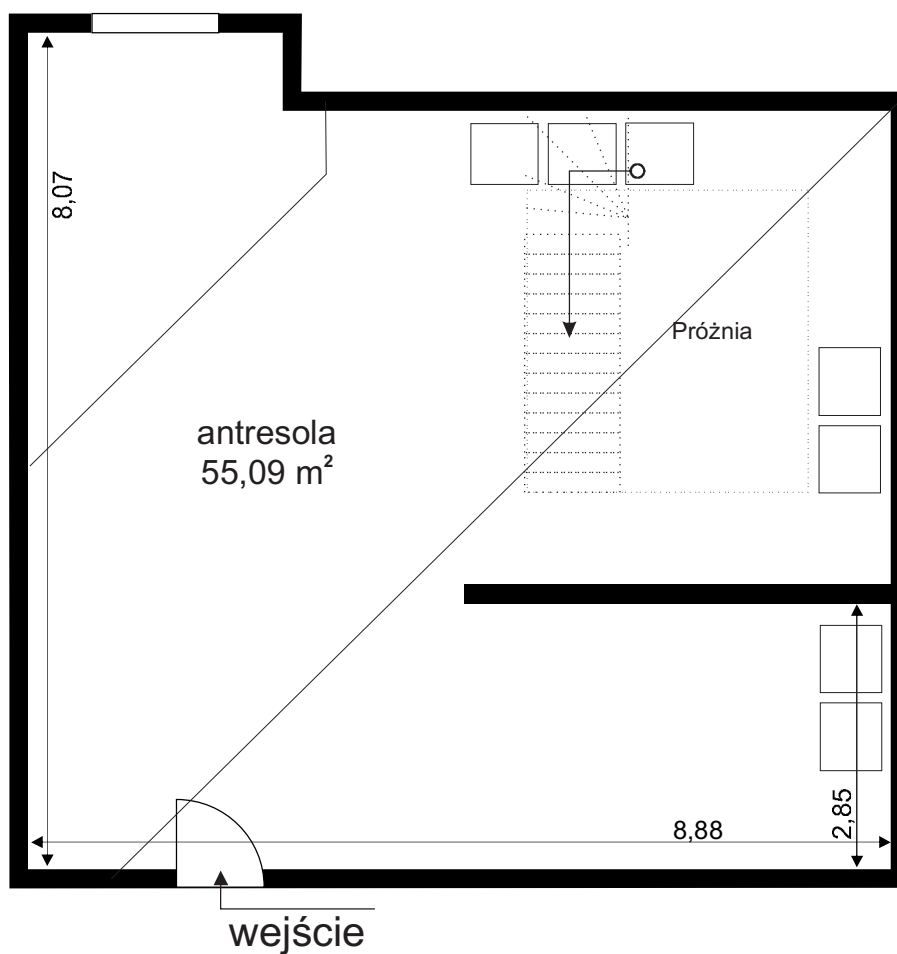
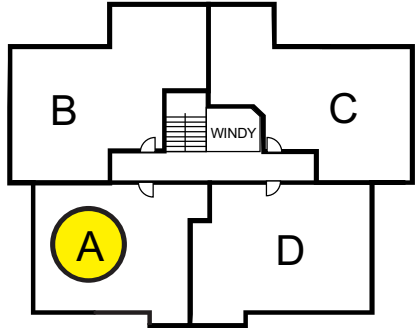

# OLMONT INVESTMENS Sp. z o.o.

ul. Ryżowa 41 02-495 Warszawa tel. (22) 867 54 37, 867 59 16 kom. 604 222 622

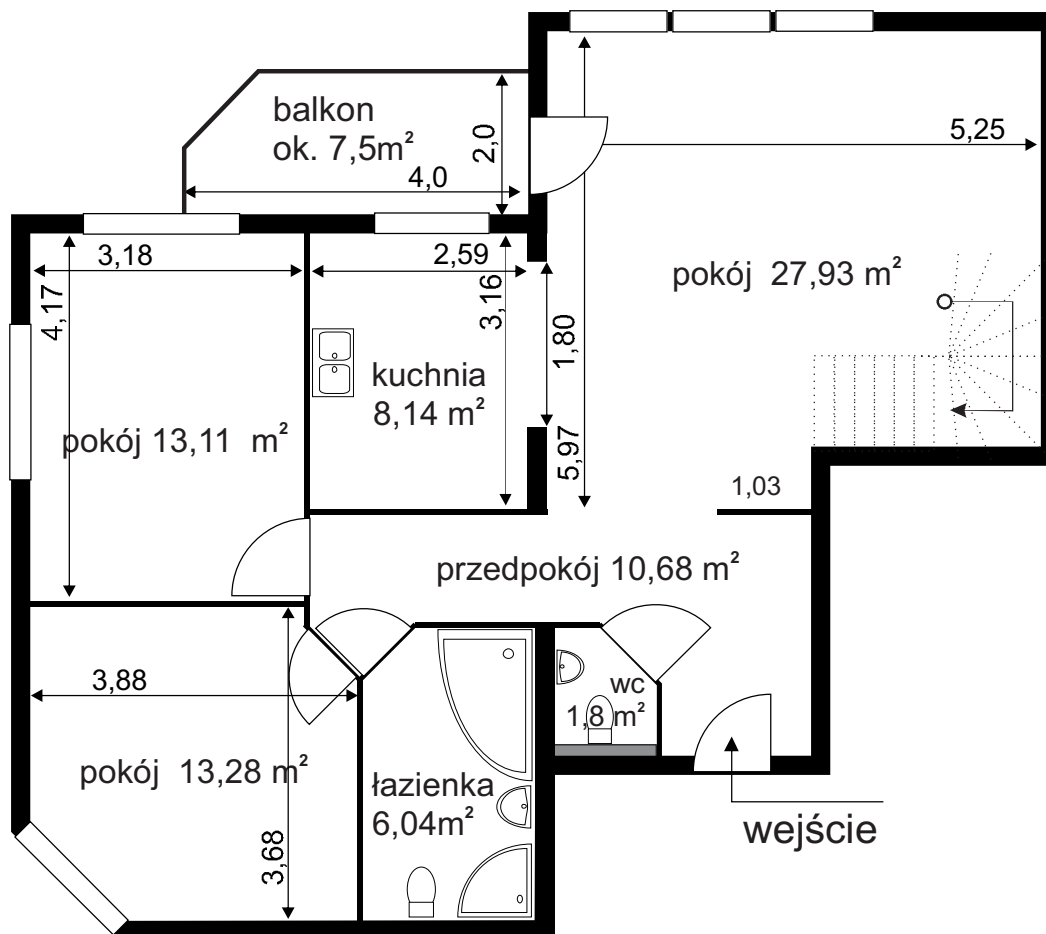
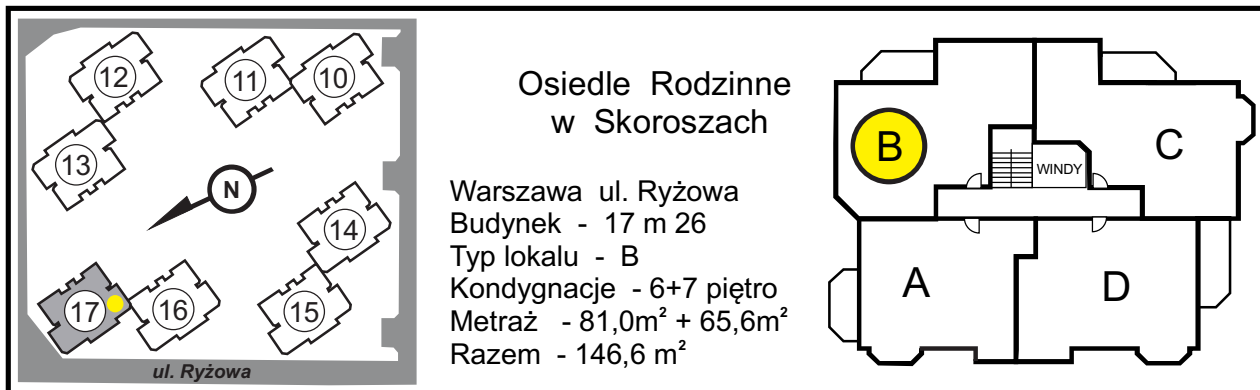

# OLMONT INVESTMENS Sp. z o.o.

ul. Ryżowa 41 02-495 Warszawa tel. (22) 867 54 37, 867 59 16 kom. 604 222 622

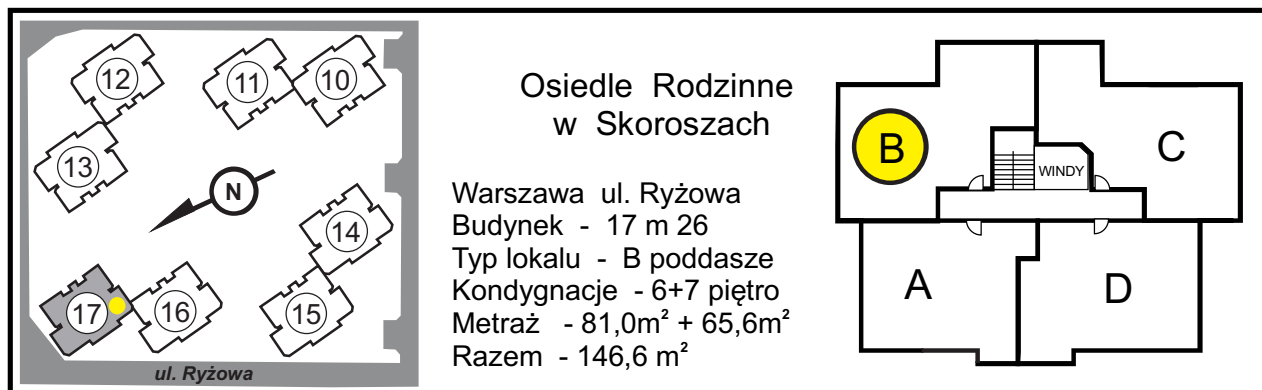

## Osiedle Rodzinne w Skoroszach

Warszawa ul. Ryżowa  
Budynek - 17 m 26  
Typ lokalu - B poddasze  
Kondygnacje - 6+7 piętro  
Metraż - 81,0m<sup>2</sup> + 65,6m<sup>2</sup>  
Razem - 146,6 m<sup>2</sup>

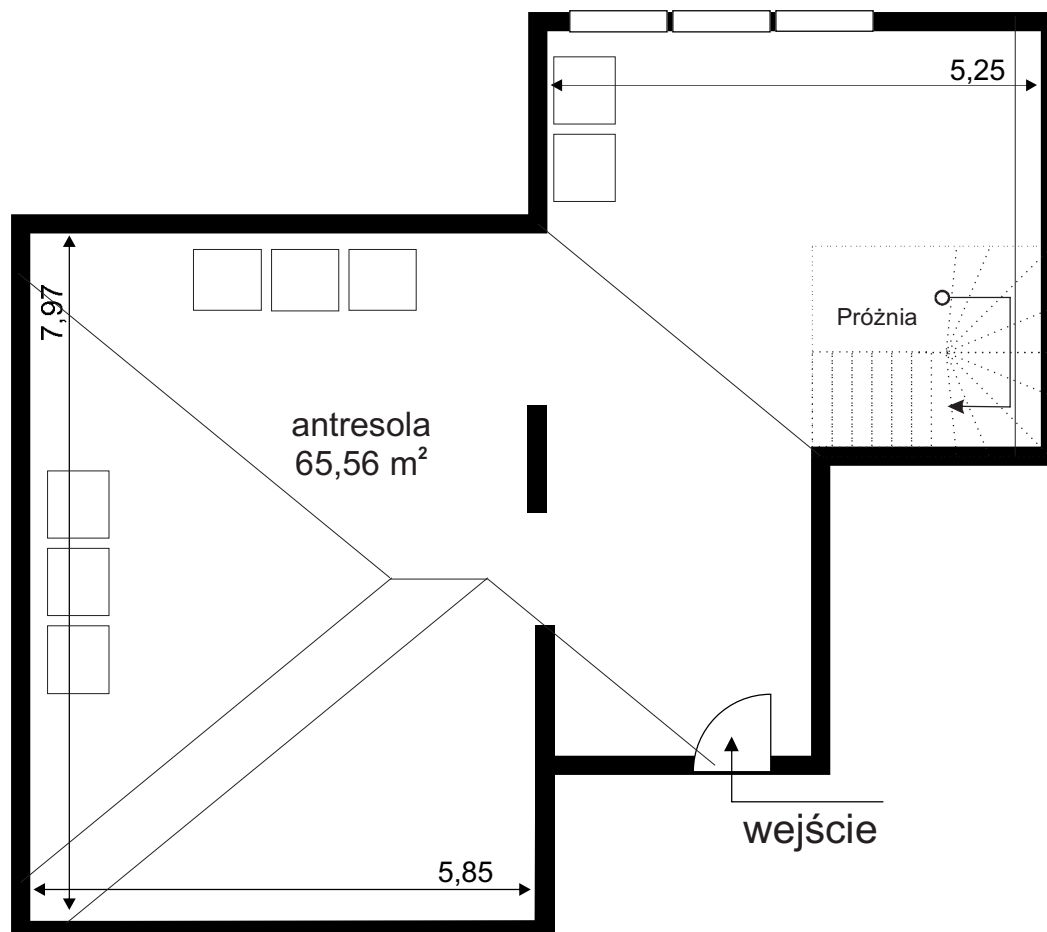

# OLMONT INVESTMENS Sp. z o.o.

ul. Ryżowa 41 02-495 Warszawa tel. (22) 867 54 37, 867 59 16 kom. 604 222 622

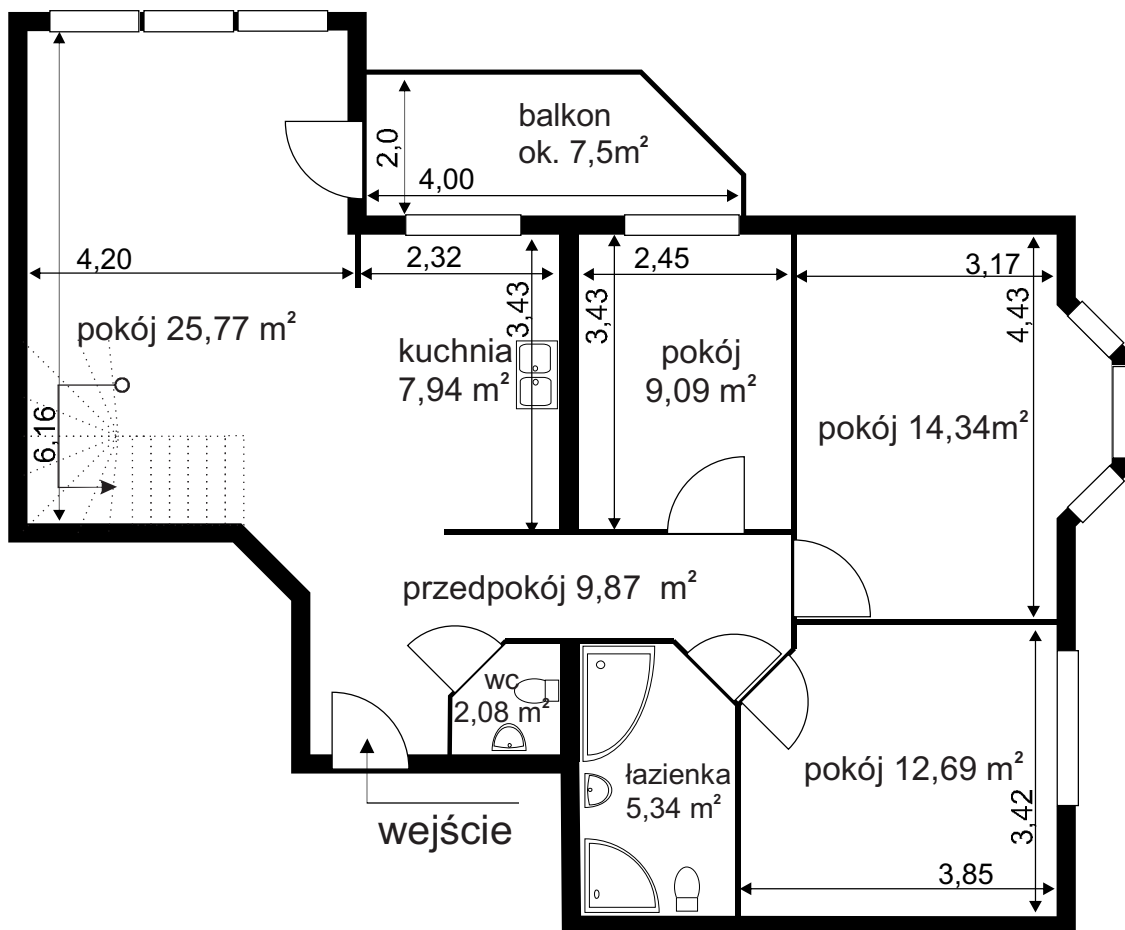
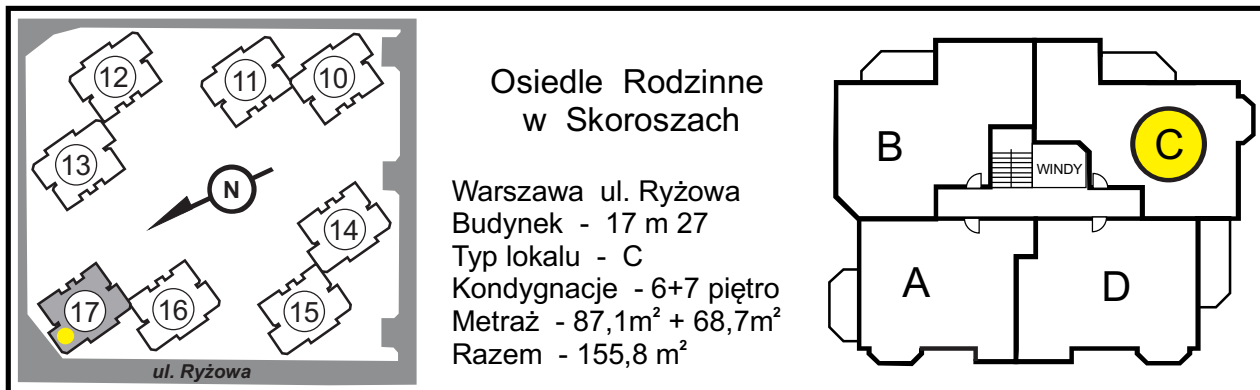

# OLMONT INVESTMENS Sp. z o.o.

ul. Ryżowa 41 02-495 Warszawa tel. (22) 867 54 37, 867 59 16 kom. 604 222 622

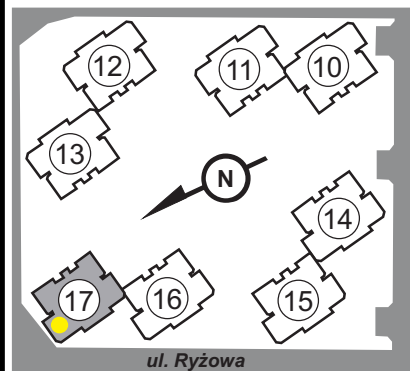

**Osiedle Rodzinne  
w Skoroszach**

Warszawa ul. Ryżowa  
Budynek - 17 m 27  
Typ lokalu - C poddasze  
Kondygnacje - 6+7 piętro  
Metraż - 87,1m<sup>2</sup> + 68,7m<sup>2</sup>  
Razem - 155,8 m<sup>2</sup>

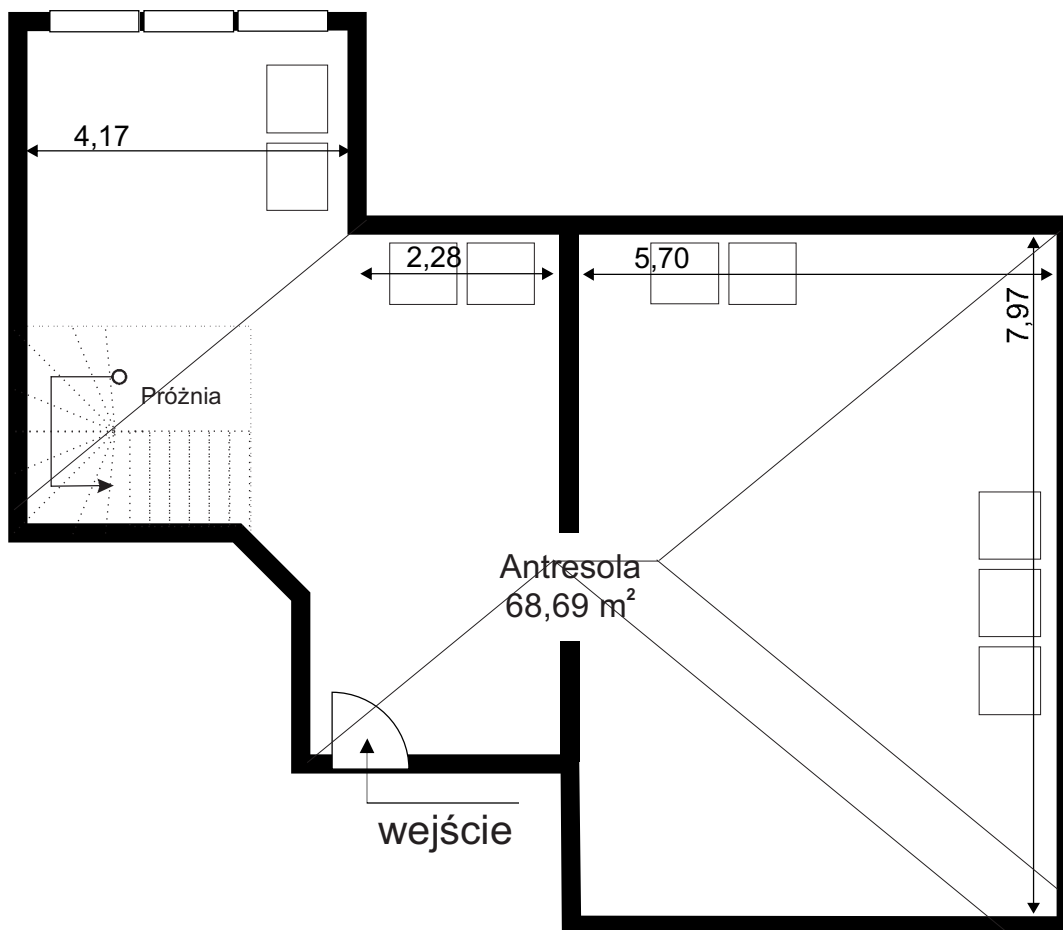
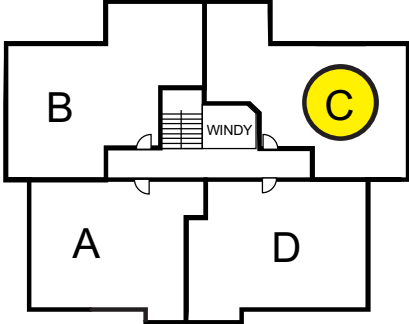

# OLMONT INVESTMENS Sp. z o.o.

ul. Ryżowa 41 02-495 Warszawa tel. (22) 867 54 37, 867 59 16 kom. 604 222 622

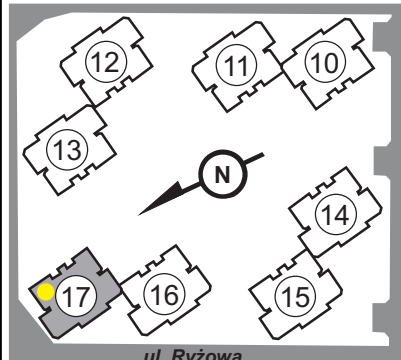

Osiedle Rodzinne  
w Skoroszach

Warszawa ul. Ryżowa  
Budynek - 17 m 28  
Typ lokalu - D  
Kondygnacje - 6+7 piętro  
Metraż - 83,9m<sup>2</sup> + 72,5m<sup>2</sup>  
Razem - 156,4 m<sup>2</sup>

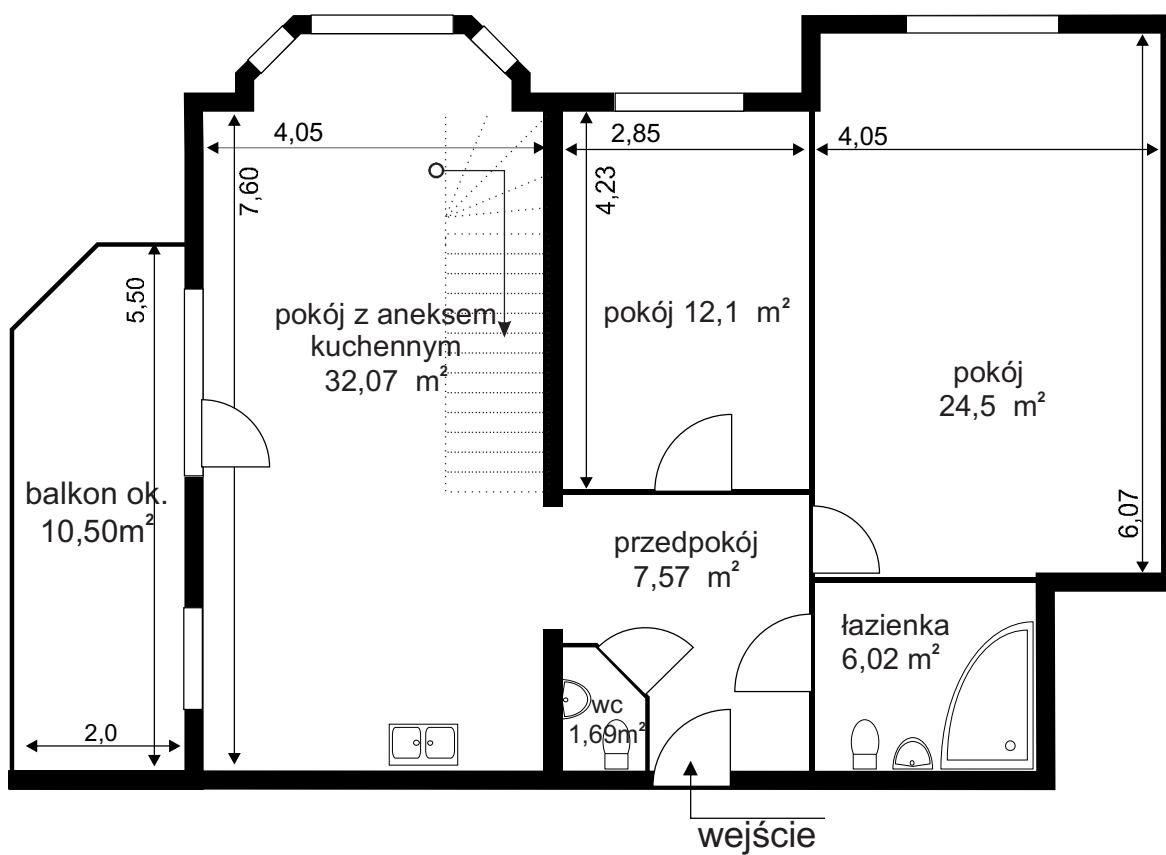
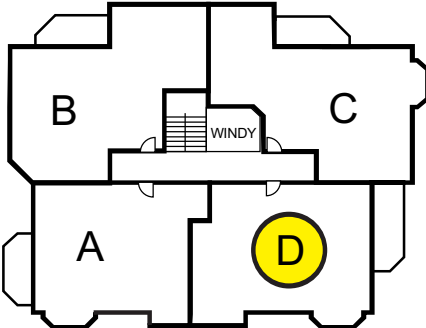

# OLMONT INVESTMENS Sp. z o.o.

ul. Ryżowa 41 02-495 Warszawa tel. (22) 867 54 37, 867 59 16 kom. 604 222 622

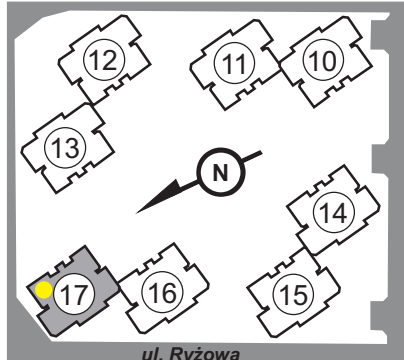

**Osiedle Rodzinne w Skoroszach**

Warszawa ul. Ryżowa  
Budynek - 17 m 28  
Typ lokalu - D poddasze  
Kondygnacje - 6+7 piętro  
Metraż - 83,9m<sup>2</sup> + 72,5m<sup>2</sup>  
Razem - 156,4 m<sup>2</sup>

